

CERTIFIED RECORD OF LAND CORNER MONUMENTATION

History of original corner establishment:

Corner originally established by David P. Thompson under GLO contract number 106, dated August 16, 1864. Surveyor General record states:

Set stone 18x12x4 in for ¼ sec corner

Corner reestablished by George S. Pershin under GLO contract number 430, dated March 23, 1882. Surveyor General record states:

After having subdivided nearly all of this township (T3S R32E) and failed to find the corners on the North boundary. . . I rerun this North boundary.  
 Set a basalt stone 14x8x6 in 10 ins in the ground on NW slope for ¼ sec cor marked ¼ on N face from which:  
 A Tamarack 10 in dia brs N18°W 5 lks dist marked ¼S BT  
 A Tamarack 13 in dia brs South 9 lks dist marked ¼S BT

No record of subsequent monumentation found in Umatilla County survey records.

Description of corner evidence found:

Found stone 14x10x5 inches set 7 inches in the ground, marked ¼ on North face.

Found a 18 inch diameter Tamarack South, 9 lks. Tree is cut off approximately 6 ft. high, with scribing visible.

Found a root hole N18°W, 5 lks.

Distance to the existing BT is to the face of the blaze.

See survey dated September, 1988.

Description of monument and accessories I established to perpetuate the

original location of this corner: In place of the found original corner stone, I set a 2½" x 30" aluminum pipe with aluminum cap marked as shown, 28 inches in the ground, from which:

New BTs:

A 10 inch diameter Douglas Fir bears N22°E, 70.24 feet marked ¼ S35 BT  
 A 5 inch diameter Lodgepole Pine bears N60°W, 15.3 feet marked X BT  
 (Did not set a spike in the 5 inch tree. Distance to the center of the tree.)

Raised a small mound of stone around monument.  
 Painted a 6 inch red band around all BTs and attached bearing tree and land survey monument signs.  
 Set a steel fencepost 3.93 feet East with land survey monument sign attached.

Buried the original corner stone Southwest and alongside of monument.

I hereby certify that the above corner point was perpetuated as hereon described on August 24, 1988.

Witnesses: Jeff Petersen and Rick Robinson

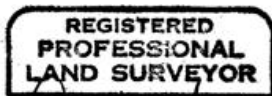
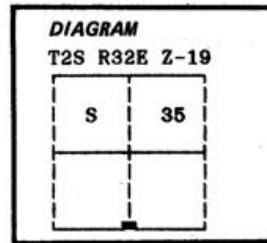

I used a steel tape and magnetic compass in the establishment of new accessories. I used 17° East magnetic declination and the distances are to a 50d spike driven in the right side of the root crown unless otherwise noted. I attached a brass washer marked OPLS 644 to the BT blaze.

Office of Surveying County of Umatilla  
 State of OR I hereby certify that the within instrument was filed in this office for record on the 22<sup>nd</sup> day of September 1988  
 Dated H. Kummbrin by Kathleen K. Amstrong  
 (COUNTY OFFICIAL) (DEPUTY)

Form R6-7100-57 (9/71)

RECEIVED BY

★ U.S. GOVERNMENT PRINTING OFFICE - 1983-793-276

Umatilla County Surveyor  
 Date 9-88  
 Rec'd By KA  
 No. 88-62-C