

Index  
File No. Z-25  
T 2S R. 32E  
Merid. Willamette

**CORNER RECORD (SEARCH)**  
(Ref. FSM 7151.4)

R.D. Ukiah County Umatilla  
N.F. Umatilla State Oregon

Tract or Survey No. \_\_\_\_\_  
Cor. No. 700051

**CORNER DIAGRAM**



**DESCRIBE CORNER MONUMENT FOUND**

Could find no evidence of the original post.

**DESCRIBE BEARING TREES OR OTHER OFFICIAL ACCESSORIES FOUND**

Found a P. Pine 34" dia. with visible scribing faint "32E S36".  
A P. Pine 26" dia. with visible scribing "R32E S1 BT". A dead  
Fir 20" dia. with healed over blaze for S.E. BT. Could find  
no trace of original NW BT.

**PHOTO IDENTIFICATION DATA**

Photo No. \_\_\_\_\_  
Filed At. \_\_\_\_\_  
Object Ident. \_\_\_\_\_  
Ident. By \_\_\_\_\_  
*Signature*

**DESCRIBE CORNER LOCATION RELATIVE TO NEAR-BY FEATURES, ALSO HOW TO REACH CORNER**

The corner falls in a clearing approximately 50 ft. south of  
E-W fence and at end of USFS Road 5411.

**PLANE COORDINATE POSITION DATA**

State \_\_\_\_\_ Zone \_\_\_\_\_  
X \_\_\_\_\_  
Y \_\_\_\_\_  
Estab. By \_\_\_\_\_  
*Agency*

*Signature*  
*Handwritten Signature*

Title \_\_\_\_\_ Division ORLS Headquarters 1294 Date 9/77  
7100-52-(3/68)

**CORNER RECORD (PERPETUATION)**

**MONUMENT: DESCRIBE NEW MONUMENT SET, OR WORK DONE TO PRESERVE EXISTING MONUMENT**

T2S

R32E  
S36

At the point which best fits Record Bearings and distances from original BTs. Set 2½"x30" galvanized pipe with brass cap stamped: Set pipe 15" in ground to rock with mound of stone to cap.

S5  
T3S R33E  
1980

OR PLS 1294

**ACCESSORIES : DESCRIBE NEW BT'S WITNESS OBJECTS ETC. ESTABLISHED, OR WORK DONE TO PRESERVE EXISTING EVIDENCE**

Old Trees: A P. Pine 34" dia. bears N30<sup>0</sup>W, 78.1' with visible scribing faint "32E S36"  
 A P. Pine 26" dia. bears S47<sup>0</sup>W, 140.6 ft. with visible scribing "R32E S1 BT".  
 A Dead Fir 20" dia. bears S35<sup>0</sup>E, 116.9 ft. with healed over blaze  
 New Tree: A Doug. Fir 14" dia. bears N68<sup>0</sup>W, 112.2 ft., scribed T2S R32E S36BT.  
 Attached 54-3 and 54-4 signs to all BTs. Attached brass washer stamped LS1294 to foot blaze of new BTs. Painted blazes and 6" band around both Bts. red. Attached 54-2 & 54-4 signs to metal post 5' north of corner.

Work Done By: R.C. Orton Title Party Chief Date 7/28/80 State Registration No. \_\_\_\_\_ or Agency \_\_\_\_\_

Certified Cor. Record Prepared? Yes  No \_\_\_\_\_ Filed At: \_\_\_\_\_ Date \_\_\_\_\_

**REMARKS**

Witnesses: R. Orton  
 L. Huntsman  
 D. Allen

Index  
File No. Z-25

**CORNER RECORD (SEARCH)**  
(Ref. FSM 7151.4)

Tract or  
Survey No. \_\_\_\_\_  
Cor. No. \_\_\_\_\_

T 2 S R. 32 E R.D. Ukiah County Umatilla  
Merid. Willamette N.F. Umatilla State Oregon

CORNER DIAGRAM

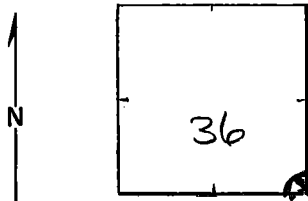

DESCRIBE CORNER MONUMENT FOUND

Material: Stone mound  
Markings: None visible (mound has been disturbed by vehicular traffic).

2

DESCRIBE BEARING TREES OR OTHER OFFICIAL ACCESSORIES FOUND

Original GLO B.T.'s still stand in SW, NW and SE quadrants. Scribing visible on B.T.'s in SW and NW quadrants. Fir in SE quadrant has closed blazes. All have B.T. tags. Stump hole exists in NE quadrant at approx. GLO distance and bearing. A fence runs east-west approx. 30 feet north of mound. The 4 B.T.'s were set when this corner was thought to be common to Townships' 2 & 3, Ranges 32 & 33. It is not. Therefore, (cont'd on back)

3

DESCRIBE CORNER LOCATION RELATIVE TO NEAR-BY FEATURES, ALSO HOW TO REACH CORNER

There is a primitive road to corner, from Pole Mill road system.

4

PHOTO IDENTIFICATION DATA

Photo No. \_\_\_\_\_  
Filed At. \_\_\_\_\_  
Object Ident. \_\_\_\_\_  
Ident. By \_\_\_\_\_  
*Signature*

6

7

PLANE COORDINATE POSITION DATA

State \_\_\_\_\_ Zone \_\_\_\_\_  
X \_\_\_\_\_  
Y \_\_\_\_\_  
Estab. By \_\_\_\_\_  
*Agency*

8

Signature  
**Tom Hollamon**

Title  
**Eng, Tech,**

Division

Headquarters

Date  
**11/19/75**

7100-52 (3/68)

5

CORNER RECORD (PERPETUATION)

MONUMENT: DESCRIBE NEW MONUMENT SET, OR WORK DONE TO PRESERVE EXISTING MONUMENT

ACCESSORIES : DESCRIBE NEW BT's WITNESS OBJECTS ETC. ESTABLISHED, OR WORK DONE TO PRESERVE EXISTING EVIDENCE

Work Done By \_\_\_\_\_ Title \_\_\_\_\_ Date \_\_\_\_\_ State Registration No. or Agency \_\_\_\_\_

Certified Cor. Record Prepared ? Yes No Filed At: \_\_\_\_\_ Date \_\_\_\_\_

REMARKS

(cont'd from 3) the B.T. in the NW quadrant should be the only one properly scribed. However, the other two remaining B.T.'s are good references.

Index File No. T. R. M. Tract or Surv. No. Cor. \_\_\_\_\_