

OREGON CORNER RESTORATION FORM

Section 17 Township 2S Range 33E
 County Umatilla Date: October 30, 2002

Corner Designation: 2S33N9

Corner to sections 16, 17, 20, and 21, T2S, R33E,
 W.M., Umatilla County, Oregon.

Condition Report Only
 Not found
 Remonumented
 Unrecorded
 Surveyed in
 Referenced out

Previous Renewals / Surveys, etc.

Corner originally set by John C. Arnold under contract #551 dated March 19, 1890.
 His record reads: Set basalt stone, 16 x 8 x 8 ins., 12 ins. in ground for cor. to secs. 16, 17, 20 & 21, marked 3 notches on S. edge and 4 notches on E. edge; dug pits, 18 x 18 x 12 ins, in each Sec. Cor., 5 1/2 ft. dist. Raised mound of earth, 2 ft. high x 4 1/2 ft. base over stone on N. hillside.

Monument and Accessories found: (condition and source)

The original stone, plainly chisled, firmly in place. The position fits the calls to the ravine very well.

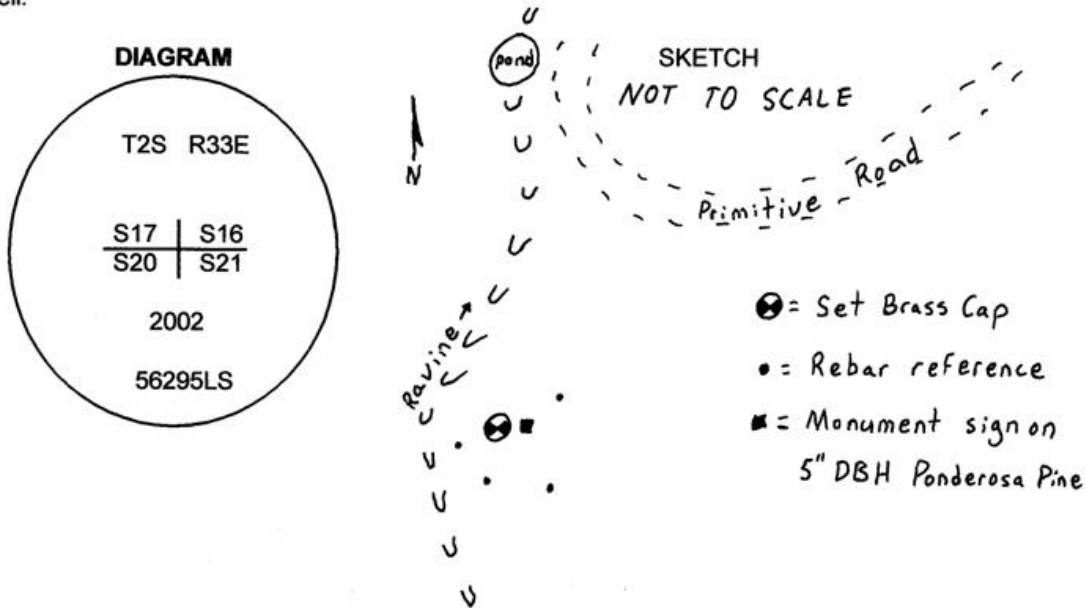

MONUMENT (S) AND ACCESSORIES SET (Procedures and Description)

Set a 1 1/2" x 30" galvanized iron pipe with a 2 1/4" brass cap stamped as shown in the diagram above at the position of the original stone. Buried the stone upside down along the west side of the monument. Attached a county monument sign to a nearby 5" dbh Ponderosa pine.

For references, I set four, 5/8" by 24" rebars with 1.25" orange plastic caps attached, stamped WTS and 56295LS as described below:

- an iron rebar bears N68°34'12"E, 28.98 feet;
- an iron rebar bears S33°28'24"E, 28.41 feet;
- an iron rebar bears S31°42'46"W, 41.97 feet;
- an iron rebar bears S76°33'08"W, 41.08 feet;

The monument and references were tied using a LIECA system 300 RTK GPS.

Location and comments

Compass Declination

Surveyors Seal

RECEIVED BY:
Umatilla County Surveyor
 Date: 2-03
 Rec'd By: KK
 No. 03-24-B

Firm / Agency
 Haddock Surveying
 Address
 P.O. Box 1574
 Pendleton, Or. 97801
 Party Chief
 Stephen K, Haddock

REGISTERED
 PROFESSIONAL
 LAND SURVEYOR

Stephen K. Haddock

OREGON
 JULY 9, 2001
 STEPHEN K. HADDOCK
 56295LS

RENEWAL DATE 6-30-03