

OREGON CORNER RESTORATION FORM

Section 25 Township 2S Range 33E
 County Umatilla Date: April 26, 2000

Corner Designation: 2S33T21

Common quarter corner to sections 25 and 26, T2S, R33E, W.M., Umatilla County, Oregon.

Condition Report Only
 Not found
 Remonumented
 Unrecorded
 Surveyed in
 Referenced out

Previous Renewals / Surveys, etc.

Corner originally set by John C. Arnold under contract #551 dated March 19, 1890.
 His record reads: Set basalt stone, 30 x 18 x 5 ins., 18 ins. in ground for 1/4 section cor. marked 1/4 on W. face, raised a mound of stone 4 ft. high by 6 ft. base over cor. on stony S. hillside.

Monument and Accessories found: (condition and source)

The original stone plainly chisled 1/4 was lying on its face beside a mound of stone. There was a divot in the mound where the stone had been. A north - south fence ran beside the mound.

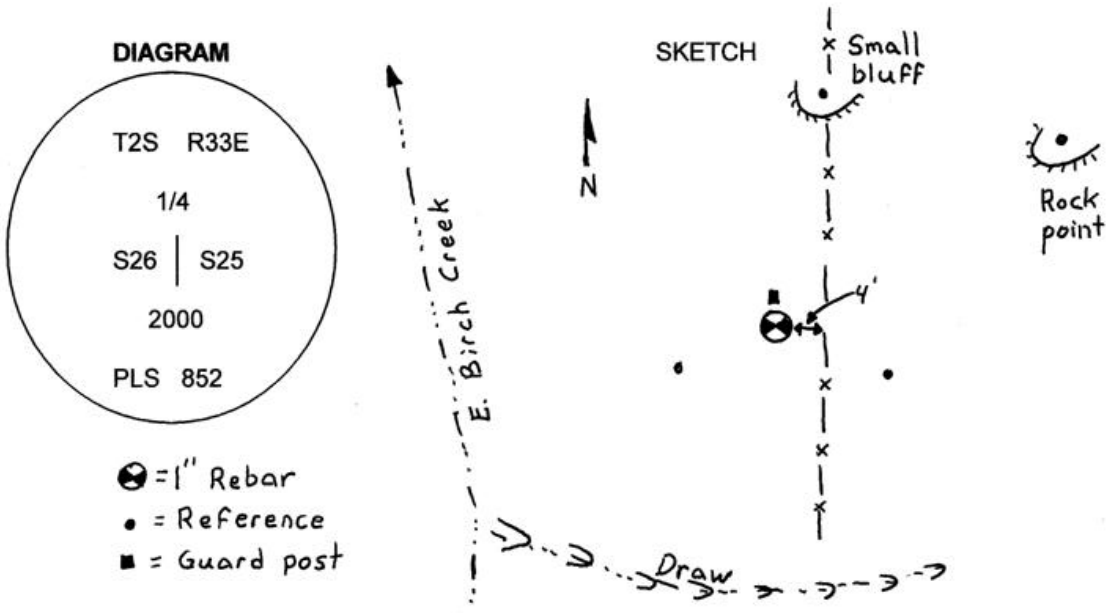

MONUMENT (S) AND ACCESSORIES SET (Procedures and Description)

Set a 1" x 24" iron rebar with a 2" aluminum cap stamped as shown in the diagram above in the original mound. Buried the stone along side. Set a 6' steel post with a county monument sign attached along side.

For references, I set four 5/8" by 24" rebars with 1.25" red plastic caps stamped ORLS 852 and WAL5 13922 as described below:

- an iron rebar bears N03°49'53"W, 61.92 feet on top of a small bluff;
- an iron rebar bears N44°47'24"E, 80.89 feet in the top of a small rock point;
- an iron rebar bears S50°20'05"E, 51.19 feet;
- an iron rebar bears S75°17'05"W, 30.59 feet;

The monument and references were tied using a LIECA system 300 RTK GPS.

Location and comments

Compass Declination

Surveyors Seal

RECEIVED BY:
Umatilla County Surveyor
 Date: 7-00
 Rec'd By: KK
 No. 00-156-C

Firm / Agency
 Haddock Surveying
 Address
 P.O. Box 1574
 Pendleton, Or. 97801
 Party Chief
 Stephen K, Haddock

