

Index  
File No. 2-1  
T 2S R. 34  
Merid. WILL.

**CORNER RECORD (SEARCH)**

(Ref. FSM 7151.4)

R.D. LA GRANDE County UNION  
N.F. W-W State ORE

Tract or  
Survey No. \_\_\_\_\_

Cor.  
No. TWP.  
COR.

**CORNER DIAGRAM**

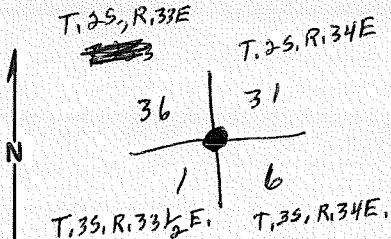

**DESCRIBE CORNER MONUMENT FOUND**

Recent BLM corner  
4 good BT's and signs.  
Sign 54-2 & 54-4 on fence post 5' north. Painted BT's

**DESCRIBE BEARING TREES OR OTHER OFFICIAL ACCESSORIES FOUND**

set during  
BLM remon in 35 33 1/2 E in 1977  
see BLM notes in 35 33 1/2 E file

**PHOTO IDENTIFICATION DATA**

Photo No. \_\_\_\_\_  
Filed At. \_\_\_\_\_  
Object Ident. \_\_\_\_\_  
Ident. By \_\_\_\_\_  
*Signature*

**PLANE COORDINATE POSITION DATA**

State \_\_\_\_\_ Zone \_\_\_\_\_  
X \_\_\_\_\_  
Y \_\_\_\_\_  
Estab. By \_\_\_\_\_  
*Agency*

**DESCRIBE CORNER LOCATION RELATIVE TO NEAR-BY FEATURES, ALSO HOW TO REACH CORNER**

Signature  
B. Barbour

Title  
RLS

Division \_\_\_\_\_

Headquarters \_\_\_\_\_

Date  
1980

7100-52-(3/68)

**CORNER RECORD (PERPETUATION)**

**MONUMENT : DESCRIBE NEW MONUMENT SET, OR WORK DONE TO PRESERVE EXISTING MONUMENT**

9

**ACCESSORIES : DESCRIBE NEW BT's WITNESS OBJECTS ETC. ESTABLISHED, OR WORK DONE TO PRESERVE EXISTING EVIDENCE**

10

Work Done By \_\_\_\_\_ Title \_\_\_\_\_ Date \_\_\_\_\_ State Registration No.  
or Agency \_\_\_\_\_

Certified Cor. Record Prepared ? Yes No Filed At: \_\_\_\_\_ Date \_\_\_\_\_

11

**REMARKS**

12

Index File No: T. R. M. Tract or Surv. No. Cor. 13

Index  
File No. A-25

**CORNER RECORD (SEARCH)**

(Ref. FSM 7151.4)

Tract or  
Survey No. \_\_\_\_\_ Cor.  
No. \_\_\_\_\_

T 95 R. 33 1/2 E

R.D. LaGrande County Union

Merid. Willamette

N.F. W-W State Oregon

**CORNER DIAGRAM**

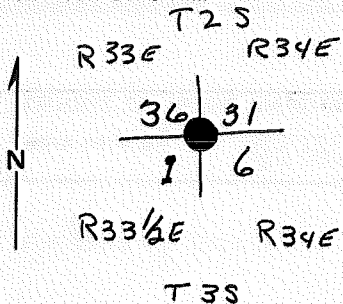

**DESCRIBE CORNER MONUMENT FOUND**

original sandstone 28x9x4" firmly set 24" in ground w/6 notches on N., S., E. + W. edges.

**DESCRIBE BEARING TREES OR OTHER OFFICIAL ACCESSORIES FOUND**

Grand fir, 24" dia, brs. N60°E, 44 fls, w/ scribe marks R34E on partially healed blaze.  
Grand fir, 37" dia, brs. S17°E, 40 fls, w/ fragmentary scribe marks visible on partially healed blaze.  
Larch snag, 20" dia, brs S42°W, 11 fls w/ scribe marks T3S R33 1/3 E Sec 31 visible on open blaze.  
Decayed pine stump, brs N25°W, 36 fls, w/ 12" dia pine alongside w/ scribe visible.

**DESCRIBE CORNER LOCATION RELATIVE TO NEAR-BY FEATURES, ALSO HOW TO REACH CORNER**

**PHOTO IDENTIFICATION DATA**

Photo No. \_\_\_\_\_  
Filed At. \_\_\_\_\_  
Object Ident. \_\_\_\_\_  
Ident. By \_\_\_\_\_

Signature

**PLANE COORDINATE POSITION DATA**

State \_\_\_\_\_ Zone \_\_\_\_\_  
X \_\_\_\_\_  
Y \_\_\_\_\_  
Estab. By \_\_\_\_\_  
Agency

Signature

Title

Division

Headquarters

Date

FS-7100-52 (3/68)

**CORNER RECORD (PERPETUATION)**

MONUMENT: DESCRIBE NEW MONUMENT SET, OR WORK DONE TO PRESERVE EXISTING MONUMENT

Set iron post w/ Brass Cap mkd:

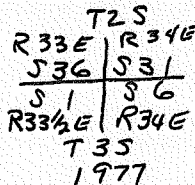

ACCESSORIES : DESCRIBE NEW BT'S WITNESS OBJECTS ETC. ESTABLISHED, OR WORK DONE TO PRESERVE EXISTING EVIDENCE

A Sir, 11" dia, bears S 56°W, 52 lbs, mkd T6S, R33½E., S1 BT.

A Sir, 19" dia, bears N 75°W, 31½ lbs, mkd. T2S, R33E S36 BT

Deposit corner stone alongside iron post.

Work Done By BCM Title \_\_\_\_\_ Date 8/77 State Registration No. or Agency \_\_\_\_\_

Certified Cor. Record Prepared ? Yes  No  Filed At: \_\_\_\_\_ Date \_\_\_\_\_

REMARKS