

Index

File No. N-11

**CORNER RECORD (SEARCH)**

(Ref. FSM 7151.4)

Tract or

Survey No. \_\_\_\_\_

Cor.

No. 1/4

T 2S R. 35E

R.D. La Grande County Umatilla

Merid. Willamette

N.F. Wallowa-Whitman State Oregon

**CORNER DIAGRAM**

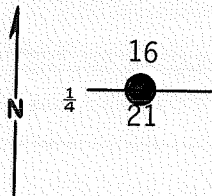

**DESCRIBE CORNER MONUMENT FOUND**

At record bearing and distance from the fir and the root hole of the Pine, we found remains of the decayed post.

**DESCRIBE BEARING TREES OR OTHER OFFICIAL ACCESSORIES FOUND**

Found: A 28" Doug. Fir axed open to face of blaze with no visible scribing. Tree is dead.

**PHOTO IDENTIFICATION DATA**

Photo No. \_\_\_\_\_

Filed At. \_\_\_\_\_

Object Ident. \_\_\_\_\_

Ident. By \_\_\_\_\_

*Signature*

**PLANE COORDINATE POSITION DATA**

State \_\_\_\_\_ Zone \_\_\_\_\_

X \_\_\_\_\_

Y \_\_\_\_\_

Estab. By \_\_\_\_\_

*Agency*

**DESCRIBE CORNER LOCATION RELATIVE TO NEAR-BY FEATURES, ALSO HOW TO REACH CORNER**

Corner falls on a steep W slope about 200 ft. above the bottom of a draw in partly open timber and about 1 ft. north of an east-west fence.

*Signature*

Title

Division

Headquarters

Date

Land Surveyor LS 1099

7100-52 (3-68)

**CORNER RECORD (PERPETUATION)**

**MONUMENT: DESCRIBE NEW MONUMENT SET, OR WORK DONE TO PRESERVE EXISTING MONUMENT**

At this established point we set 2½"x30" galvanized pipe with brass cap stamped:

T2S R35E  
S16  
¼ ———  
S21

Set pipe 25" in ground.

1982  
OR PLS 1099

**ACCESSORIES: DESCRIBE NEW BT'S WITNESS OBJECTS ETC. ESTABLISHED, OR WORK DONE TO PRESERVE EXISTING EVIDENCE**

From Which:

The original Fir BT still standing bears S10°W 5.25 ft.

New BT's:

A White Fir 10" dia. bears N29°E 42.0 ft., marked 1/4 S16 BT.

A Tamarack 17" dia. bears S74°E 45.1 ft., marked 1/4 S21 BT.

Work Done By G. Wagoner Title Party Chief Date 7/29/82 State Registration No. \_\_\_\_\_  
or Agency \_\_\_\_\_

Certified Cor. Record Prepared? Yes  No \_\_\_\_\_ Filed At: Umatilla Co. Survey. Office Date \_\_\_\_\_

**REMARKS**

Painted blazes and attached signs per Standard Specifications for Cadastral Surveys, USFS Region 6, Oct., 1979.

Compass Declination: 18½° E

Witnesses: G. Wagoner  
R. Scott

**CORNER RECORD (SEARCH)**  
(Ref. FSM 7151.4)

Index  
File No. N-11  
T 2S R. 35 E  
Merid. WILLAMETTE

Tract or Survey No. \_\_\_\_\_  
S. 1/4 COR.  
Cor. No. SEC. 16

R.D. LA GRANDE County UNION  
N.F. WALLOWA-WHITMAN State OREGON

**CORNER DIAGRAM**

**DESCRIBE CORNER MONUMENT FOUND**

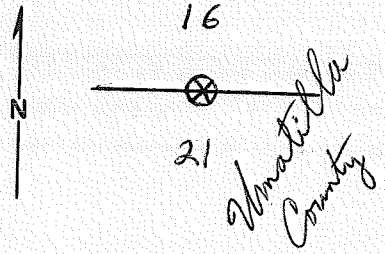

**DESCRIBE BEARING TREES OR OTHER OFFICIAL ACCESSORIES FOUND**

lodgepole pine, 14" is dead and down, Scribed 1/4 S, blazed fir 26" dia. in proper location.

*32" DF in sec. 21 snag scribe visible Dahlstrom 1-7-81*

**PHOTO IDENTIFICATION DATA**

Photo No. \_\_\_\_\_  
Filed At. \_\_\_\_\_  
Object Ident. \_\_\_\_\_  
Ident. By \_\_\_\_\_  
*Signature*

**DESCRIBE CORNER LOCATION RELATIVE TO NEAR-BY FEATURES, ALSO HOW TO REACH CORNER**

**PLANE COORDINATE POSITION DATA**

State \_\_\_\_\_ Zone \_\_\_\_\_  
X \_\_\_\_\_  
Y \_\_\_\_\_  
Estab. By \_\_\_\_\_  
*Agency*

Signature  
**DAVE DAHLSTROM**

Title \_\_\_\_\_ Division \_\_\_\_\_ Headquarters \_\_\_\_\_

Date  
**6/4/71**

7100-52-(3/68)

## CORNER RECORD (PERPETUATION)

MONUMENT : DESCRIBE NEW MONUMENT SET, OR WORK DONE TO PRESERVE EXISTING MONUMENT

9

ACCESSORIES : DESCRIBE NEW BT'S WITNESS OBJECTS ETC. ESTABLISHED, OR WORK DONE TO PRESERVE EXISTING EVIDENCE

10

Work Done By \_\_\_\_\_ Title \_\_\_\_\_ Date \_\_\_\_\_ State Registration No.  
or Agency \_\_\_\_\_

Certified Cor. Record Prepared ? Yes No Filed At \_\_\_\_\_ Date \_\_\_\_\_

11

REMARKS

12

Index File No. T. R. M. Tract or Surv. No. Cor. 13