

Form 874-9—Revised May, 1918

U. S. DEPARTMENT OF AGRICULTURE  
FOREST SERVICE

Umatilla NATIONAL FOREST

CORNERS OF THE PUBLIC SURVEY

T. 18 R. 36 E Mer. W

1/4 Corner common to Sections  
South Sec 35 and \_\_\_\_\_

Corner consists of a Mound of rock (net) in place  
State condition Good

Dimensions above ground 10 inches.  
Sketch grooves, letters, figures, or notches, on proper face or edge.

CARDINAL POSITION

DIAGONAL POSITION

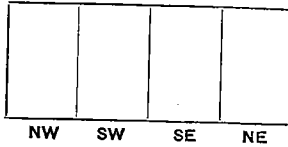
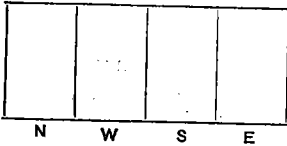

Mound of \_\_\_\_\_ is located \_\_\_\_\_

Pits are located \_\_\_\_\_

Sketch markings of Bearing Trees (or Rocks) in proper box and fill blanks below, giving bearings from Corner to Trees and Distances in Links.

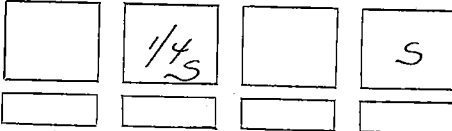

Species	<u>DF Snag</u>	<u>YP</u>
Diameter	<u>26"</u>	<u>19"</u>
Bearing	<u>S22W</u>	<u>N8E</u>
Distance	<u>84 Lks</u>	<u>1 1/2 Ch</u>

Do you believe this to be a genuine Land Office Corner? Yes  
If not, why? \_\_\_\_\_

J. D. Monroe  
Signature

July 23 1929  
Date

J. J.  
Title

T. 18 R. 36E W. Mer.

8-3027

(Make sketch of topography near Corner.)

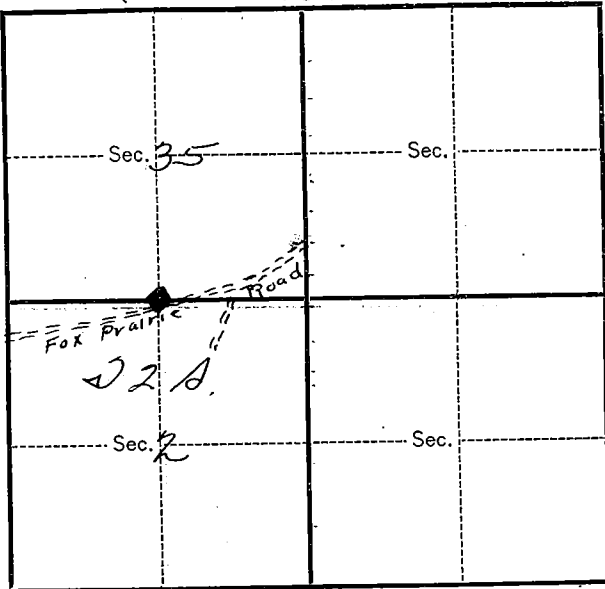

Metal Location Poster is on a YP  
tree 19 inches diameter, on the SW  
side of the tree  
from which this Corner bears S 8 W  
1 1/3 chains distant.

Give any further facts which will aid in finding this  
Corner, again.

Type YP. Open glade  
in a L D F type. The  
Fox Prairie road runs  
about 2 chain south  
of the corner, a  
crusher tag is on the  
road where the section  
line crosses.

Index File No. Z-19

CORNER RECORD (SEARCH)

Tract or Survey No. Z 19

Car. No. 83  
1/4

T 1 S 36 E

R.D. Pendleton

County Umatilla

Merid. Willamette

N.F. Umatilla

State Oregon

CORNER DIAGRAM

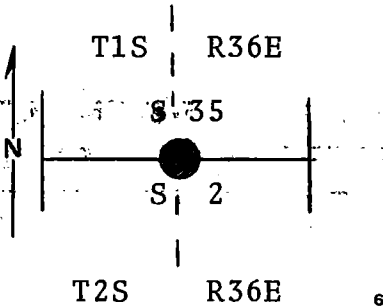

DESCRIBE CORNER MONUMENT FOUND

Brass cap set summer 1972.

DESCRIBE BEARING TREES OR OTHER OFFICIAL ACCESSORIES FOUND

Found 24" ponderosa pine, live in good conditon, marked 1/4 S, positioned 1/4 corner between section 35 and 2, S14° W, 91 ft. dist. from notch in blaze.

PHOTO IDENTIFICATION DATA

Photo No. \_\_\_\_\_

Filed At. \_\_\_\_\_

Object Ident. \_\_\_\_\_

Ident. By \_\_\_\_\_

*Signature*

PLANE COORDINATE POSITION DATA

State \_\_\_\_\_ Zone \_\_\_\_\_

X \_\_\_\_\_

Y \_\_\_\_\_

Estab. By \_\_\_\_\_

*Agency*

Signature

Title

Division

Headquarters

Date

7100-52

REV. 65 5



CORNER RECORD (PERPETUATION)

MONUMENT. DESCRIBE NEW MONUMENT SET, OR WORK DONE TO PRESERVE EXISTING MONUMENT

Set 30x2½" iron pipe with 3" brass cap marked as shown 6" in the ground to solid rock and chiseled and "X" in rock under pipe for the 1/4 section corner between sections 35 and 2, and raised a mound of stone 4 ft. in diam. and 2½ ft. high around the pipe, from which new BTs.

ACCESSORIES : DESCRIBE NEW BT'S WITNESS OBJECTS ETC. ESTABLISHED, OR WORK DONE TO PRESERVE EXISTING EVIDENCE

A 20" fir bears S60°W 86.9 ft. marked T2S R36E 1/4 S2 BT.  
Measurement taken to a brass washer in face of blaze.  
Set steel fence post approx. 5 ft. West with warning sign attached.  
Used steel tape and magnetic compass with declination = 20° East.

Work Done By D. M. Ferguson Title Land Surveyor Date 7/12/69 State Registration No. 848  
or Agency  
Certified Cor. Record Prepared?  Yes No Filed At Umatilla Co. Courthouse Date 11/16/72

REMARKS

Index File No. Z-19 T. R. M. Tract or Surv. No. Cor. 12 13