

OREGON CORNER RESTORATION FORM

Section 4 Township 3N Range 28E
 County Umatilla Date: 06-14-02

Corner Designation: 3N28A11

_____x_____	Condition Report Only
_____	Not Found
_____	Remonumented
_____	Unrecorded
_____x_____	Surveyed In
_____	Referenced Out

Previous Renewals / Surveys, etc.

Survey S-156-C records setting a brass cap at this point.

Monument and Accessories Found: (condition and source)

Found a brass capped monument as described below.



SKETCH

DIAGRAM

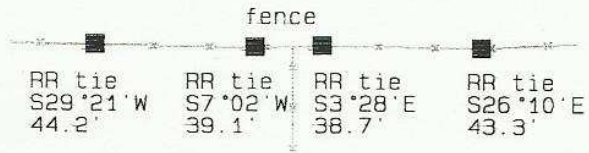
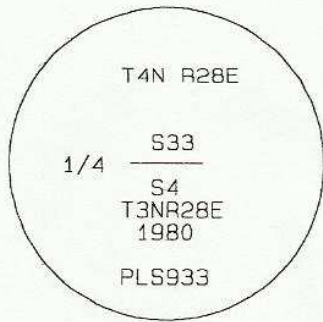

MONUMENT (S) AND ACCESSORIES SET (Procedures and Description)

None.

REFERENCES SET:

None.

Made GPS tie to TRI Station
 Stanfield East Base.
 Latitude 45°46'38.30504"N
 Longitude 119°19'17.43484"W
 NAD 83 (1991)

Oregon State Plane Coord. - North Zone
 Northing 771691.80
 Easting 8502780.67
 Ortho Height 631.92
 Ellipsoidal Height 562.04

Location and Comments

Compass Declination

Surveyors Seal

From the junction of I84 and Highway 207, go south 0.6 miles. Take a road through the stock yard east 0.1 mile and cross the irrigation canal. Follow a circle road northeasterly 0.3 mile to a fence. Follow this fence north 0.2 mile to the corner.

20°E

REGISTERED
PROFESSIONAL
LAND SURVEYOR

RECEIVED BY:

Firm / Agency

David L. Haddock

Date: 7-02
 Rec'd By: KE
 No. 02-185-9

Haddock Surveying
 P. O. Box 1574
 Pendleton, OR 97801
 (541) 276-2174

OREGON
JULY 12, 1968
DAVID L. HADDOCK
852

RENEWS 6-30-03