

**OREGON CORNER RESTORATION FORM**

Section 6 Township 3N Range 29E  
County Umatilla Date: 12/31/08

Corner Designation: 3N29A1

Section corner common to T3N29ES6, T3N28S1, T4N28S36, T4N29ES31

- Condition Report Only
- Not Found
- Remonumented
- Unrecorded
- Surveyed In
- Referenced Out

**Previous Renewals / Surveys, etc.**

Originally Surveyed by Gates in 1859. He set a post in a mound of earth.  
In 1972 Staebler set a 3" brass cap in concrete see survey #H-107-B.  
In 1995 Edwards found a 3" B.C.  
In 2002 Haddock found a 3" B.C.  
In 2002 Primm found a 3" B.C.

**Monuments and Accessories Found: (Condition and Source)**

An aluminum tag #951 on a power pole lies N 45°30' W, 74.97'.  
An aluminum tag #951 on a railroad tie fence post lies N 72°00' E, 74.05'.  
An aluminum tag #951 on a power pole lies S 64°00' W, 46.41'.  
A 3" B.C.

**Diagram**

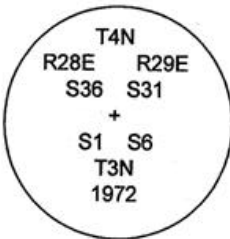

Alum. Tag  
Power Pole  
N45°30'W  
74.97'

**Sketch**

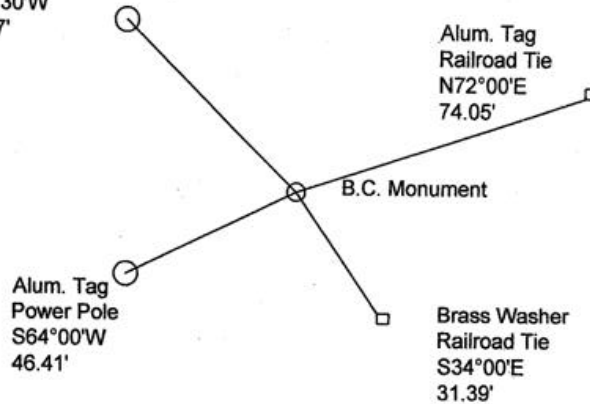

NAD 83/91  
OREGON STATE PLANE NORTH  
INTERNATIONAL FEET

N771812.00  
E8521408.51

LAT - 45° 46' 36.72601" N  
LON - 119° 14' 54.61316" W

**Monument (s) Set (Procedures and Description)**

None.

**References Set:**

A brass washer #43406 and nail on a railroad tie fence post lies S 34°00' E, 31.39'.

**Location and Comments**

From the intersection of Echo Meadows Rd. and Umatilla Meadows Rd. go West .5 miles to the corner.

**Compass Declination**

17° E

**Surveyors Seal**

REGISTERED  
PROFESSIONAL  
LAND SURVEYOR

*Robert D. English*  
OREGON  
JANUARY 11, 2005  
ROBERT DOUGLAS ENGLISH  
43406LS

**RECEIVED BY:**

Date: 1-11  
Rec'd By: KE  
No. 11-008-B

**Firm / Agency**

Survey One, LLC.  
P.O. Box 382  
Pendleton, OR 97801  
(541) 276-2055

RENEWAL DATE: 12/31/09