

OREGON CORNER RESTORATION FORM

COUNTY: Umatilla. DATE: 03/07/23.

CORNER DESIGNATION: C-1, the West Quarter Corner of Section 6, Township 3 North, Range 28 East, W.M.

PREVIOUS RENEWALS/SURVEYS ETC: Corner was originally established by N.H. Gates under Contract No. 84, dated July 22, 1859. Gates set a post in earth mound. The corner was reestablished by single proportion measure by Otis Gould, U.S Department of the Interior Surveyor in 1940. Gould remonumented the corner with a 3' by 1" iron post with brass cap. All subsequent surveys in the area have held this corner reestablished by Gould.

MONUMENT AND ACCESSORIES FOUND: Found 2 1/2" brass cap on iron pipe at ground level, inside a 10" pvc casing, with a lone wood post 3' North of corner monument. There is also a badly bent steel fence post with witness post sign 2' West of the corner. The monument cap is stamped as shown in Monument Marking Detail.

MONUMENT MARKING DETAIL:

1
4
S1|S6
1940

MAINTAINED CORNER MONUMENT:

New accessories:

- A 5/8"X24" rebar with blue plastic cap marked "Wells Surveying 54657PLS" bears N 35°43'26" E, 36.44'.
- A 5/8"X24" rebar with blue plastic cap marked "Wells Surveying 54657PLS" bears S 43°20'57" E, 65.34'.
- A 5/8"X24" rebar with blue plastic cap marked "Wells Surveying 54657PLS" bears S 29°46'13" W, 55.59'.
- A 5/8"X24" rebar with blue plastic cap marked "Wells Surveying 54657PLS" bears N 68°41'21" W, 57.97'.

I did not attach bearing object signs to the rebar accessories because they fall in a straw storage area with lots of tractor traffic. I nailed a witness post sign to the wood post 3' North of the corner monument and set a steel fence post 6" South of monument with witness corner sign attached.

Courses to corner accessories are State Plane Grid bearings and distances.

LOCATION AND COMMENTS:

Falls in straw bale storage area.

OREGON STATE PLANE COORDINATE, North Zone NAD 83(91), International Feet Units:

N: 768934.55
E: 8489798.17

FIRM: Wells Surveying
P.O. Box 1696
Pendleton, OR 97801

Surveyor's Seal

\3N28C-1

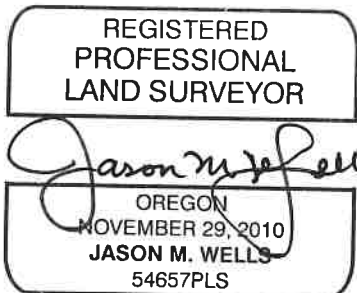

RENEWS: 6:30:24

24-004-c