

OREGON CORNER RESTORATION FORM

COUNTY: Umatilla. DATE: 02/17/23.

CORNER DESIGNATION: E-17, the Northeast Corner of Section 10, Township 3 North, Range 28 East, W.M.

PREVIOUS RENEWALS/SURVEYS ETC: Corner was originally established by N.H. Gates under Contract No. 84, dated July 22, 1859. Gates set a post in earth mound. Survey No. 258 found in Record of Private Survey Books, sets a 20"X16"X7" inch stone for this corner in 1907. Survey S-14-B reestablishes the corner by double proportion measure in 1981 and monuments with a brass cap on iron pipe monument. Subsequent record surveys have used the brass cap monument for the corner.

MONUMENT AND ACCESSORIES FOUND: Found 2 1/2" brass cap on pipe, 4" below ground level, stamped as shown in Monument Marking Detail. On North side of brass cap found the 12"x12"x8" stone placed beside the brass cap monument on Survey No. S-14-B.

MONUMENT MARKING DETAIL:

T3N R28E
S3|S2

S10|S11
1981
PLS 1638

MAINTAINED CORNER MONUMENT:

New accessories:

- A 5/8"X24" rebar with blue plastic cap marked "Wells Surveying 54657PLS" bears N 03°12'59" E, 13.09', 6" South of UECA pole no. 3N28E039000. Nailed bearing object sign and witness post sign to pole.
- A 5/8"X24" rebar with blue plastic cap marked "Wells Surveying 54657PLS" bears N 42°29'18" E, 46.33', in North-South running fence line. Wired bearing object sign to rebar.
- A 5/8"X24" rebar with blue plastic cap marked "Wells Surveying 54657PLS" bears S 20°17'18" E, 44.00', in North-South running fence line. Wired bearing object sign to rebar.
- A 5/8"X24" rebar with blue plastic cap marked "Wells Surveying 54657PLS" bears S 34°54'59" W, 49.64', at 6" round wood post in East-West running fence line. Nailed bearing object sign to wood post.

Courses to corner accessories are State Plane Grid bearings and distances.

LOCATION AND COMMENTS: Corner is located in an unfarmed area 12'+/- South of East-West running power line, 30'+/- West of a North-South running fence line, 36'+/- North of a East-West running fence line, and at the projection of the Northerly road edge of a East running road.

OREGON STATE PLANE COORDINATE, North Zone NAD 83(91), International Feet Units:

N: 766303.37
E: 8510835.43

FIRM: Wells Surveying
P.O. Box 1696
Pendleton, OR 97801

Surveyor's Seal

\3N28E-17

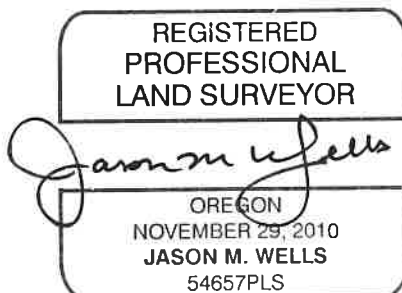

RENEWS: 6!30!24

24-004-C