

OREGON CORNER RESTORATION FORM

COUNTY: Umatilla. DATE: 04/17/23.

CORNER DESIGNATION: J-13, the Southeast Corner of Section 9, Township 3 North, Range 28 East, W.M.

PREVIOUS RENEWALS/SURVEYS ETC: Corner was originally established by N.H. Gates under Contract No. 84, dated July 22, 1859. Gates set a post in earth mound. The corner was recovered and remonumented with a stone and iron pipe in Survey No. 262, found in Record of Private Survey Books. Record surveys after Survey No. 262 do not recover evidence of this corner. The corner area has been farmed prior to irrigation circle construction.

MONUMENT AND ACCESSORIES FOUND: None. The corner area falls Northeast of a at a 4 way road intersection with private roads North-South, East and West. 1956 aerial photos show no evidence of roads at that time. The existing North-South road is graded down to about 2 feet below the native ground surface. , (thereby removing stone and iron pipe from Survey No. 262). I reestablish the corner position by double proportion measurement using the Kimbrell record from Survey No. 357 for latitude and the Gates GLO record for departure.

MONUMENT MARKING DETAIL:

T3N R28E
S9|S10

S16|S15
2023
PLS 54657

NEW MONUMENT SET:

At the position determined by survey, set a 2 1/2" brass cap on 1 1/4" by 30" galvanized iron pipe with cap 22" below ground line. The brass cap is marked as shown in monument marking detail. The corner falls approximately 12' East of the East edge of a private gravel road running North-South and 37' North of a dirt field road running East. Set a steel fence post with witness sign 1' North of corner monument.

New accessories:

- A Silver Deep-1 magnet bears N 40°08'35" E, 34.80', buried 24" below ground line.
 - A Pink Deep-1 magnet bears S 63°12'22" E, 31.51', buried 24" below ground line.
 - A Blue Deep-1 magnet bears S 57°24'57" W, 54.16', buried 24" below ground line..
 - A Orange Deep-1 magnet bears N 56°17'20" W, 53.70', buried 24" below ground line.
- Buried bearing object signs with Deep-1 magnets.

Courses to corner accessories are State Plane Grid bearings and distances.

LOCATION AND COMMENTS: See New Monument Set notes above.

OREGON STATE PLANE COORDINATE, North Zone NAD 83(91), International Feet Units:

N: 761005.87
E: 8505660.57

FIRM: Wells Surveying
P.O. Box 1696
Pendleton, OR 97801

Surveyor's Seal

\3N28J-13

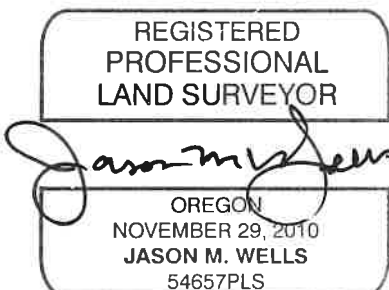

RENEWS: 6/30/24

24-004-C