

OREGON CORNER RESTORATION FORM

COUNTY: Umatilla. DATE: 02/21/23.

CORNER DESIGNATION: J-15, the South Quarter corner of Section 10, Township 3 North, Range 28 East, W.M.

PREVIOUS RENEWALS/SURVEYS ETC: Corner was originally established by N.H. Gates under Contract No. 84, dated July 22, 1859. Gates set a post in earth mound. Survey Numbers 262, (1908) and 357, (1915), found in Record of Private Survey Books, indicate the corner was surveyed through, but nothing was reported as being found or reestablished. Survey No. 97-100-B, (Partition Plat No. 1997-17), indicates a nail was set in fence post with fences East, North and South.

MONUMENT AND ACCESSORIES FOUND: None. The nail in fence post reported on Survey No. 97-100-B was not found. Found a railroad tie fence post with fences North, South and East.

MONUMENT MARKING DETAIL:

T3N R28E
S10
1/4 -----
S15
2023
PLS 54657

MONUMENT SET:

At a point just West of the fence corner post, set a 2 1/2" brass cap on 1 1/4 by 30" galvanized iron pipe 26" in the ground, marked as shown in Monument Marking Detail. Nailed Witness Post Sign to railroad tie fence corner East of Monument.

New accessories:

A 5/8"X24" rebar with blue plastic cap marked "Wells Surveying 54657PLS" bears N 89°07'41" E, 70.07' in fence line.

A 5/8"X24" rebar with blue plastic cap marked "Wells Surveying 54657PLS" bears N 89°24'20" E, 37.53' in fence line.

A 5/8"X24" rebar with blue plastic cap marked "Wells Surveying 54657PLS" bears S 02°03'43" E, 34.44' in fence line.

A 5/8"X24" rebar with blue plastic cap marked "Wells Surveying 54657PLS" bears N 00°01'06" W, 16.49' in fence line.

Wired bearing object signs to rebar accessories.

Courses to corner accessories are State Plane Grid bearings and distances.

LOCATION AND COMMENTS: Corner falls at fence intersection with fences North, South and East.

OREGON STATE PLANE COORDINATE, North Zone NAD 83(91), International Feet Units:

N: 760971.17

E: 8508306.09

FIRM: Wells Surveying
P.O. Box 1696
Pendleton, OR 97801

Surveyor's Seal

\3N28J-15

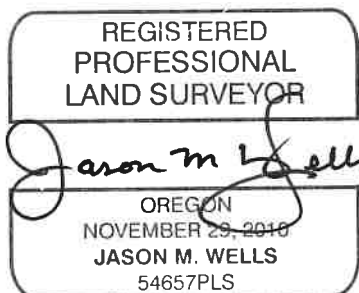

RENEWS: 6!30!24

24-004-C