

OREGON CORNER RESTORATION FORM

COUNTY: Umatilla. DATE: 03/29/23.

CORNER DESIGNATION: J-19, the North Quarter corner of Section 14, Township 3 North, Range 28 East, W.M.

PREVIOUS RENEWALS/SURVEYS ETC: Corner was originally established by N.H. Gates under Contract No. 84, dated July 22, 1859. The corner area was surveyed through on Survey No. 262, found in Record of Private Survey Books but no corner monument found or set was identified. The corner was re-established on Partition Plat No. 1997-17 and a bridge spike was set at the centerline of gravel roads to the South and East.

MONUMENT AND ACCESSORIES FOUND: Found bent 60 penny nail and flagging (reported as bridge spike) from Partition Plat No. 1997-17. Held the spin hole on the nail.

MONUMENT MARKING DETAIL:

T3N R28E
S11
1/4 -----
S14
2023
PLS 54657

NEW MONUMENT SET:

At the position of the spin hole of the 60 penny spike, set a 5/8"X14" rebar in the ground to refusal. Capped the rebar with a 2" aluminum cap marked as shown in Monument marking detail. The aluminum cap is 6" below the road surface and was surrounded by concrete for additional stability.

New accessories:

A 5/8"X24" rebar with blue plastic cap marked "Wells Surveying 54657PLS" bears N 55°07'31" E, 31.11', 6" South of railroad tie. Attached Witness post sign and bearing object sign to the railroad tie post.

A 5/8"X24" rebar with blue plastic cap marked "Wells Surveying 54657PLS" bears S 38°13'47" E, 40.10', at Northeast corner of concrete pad.

A 5/8"X24" rebar with blue plastic cap marked "Wells Surveying 54657PLS" bears S 19°43'35" W, 46.34', in North-South fence along road. Wired bearing object sign to the rebar.

A 5/8"X24" rebar with blue plastic cap marked "Wells Surveying 54657PLS" bears N 25°01'28" W, 41.10', 6" East of wood fence post. Nailed bearing object sign to the wood fence post.

Courses to corner accessories are State Plane Grid bearings and distances.

LOCATION AND COMMENTS: The corner monument is located below the road surface with gravel roads extending North, South and East.

OREGON STATE PLANE COORDINATE, North Zone NAD 83(91), International Feet Units:

N: 761049.18
E: 8513616.76

FIRM: Wells Surveying
P.O. Box 1696
Pendleton, OR 97801

Surveyor's Seal

\3N28J-19

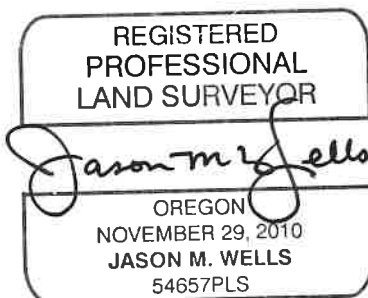

RENEWS: 6/30/24

24-004-C