

OREGON CORNER RESTORATION FORM

COUNTY: Umatilla. DATE: 04/05/23.

CORNER DESIGNATION: J-3, the South Quarter corner of Section 7, Township 3 North, Range 28 East, W.M.

PREVIOUS RENEWALS/SURVEYS ETC: Corner was originally established by N.H. Gates under Contract No. 84, dated July 22, 1859. Gates set a post in earth mound. Survey Number 198, (1904) found in Record of Private Survey Books, reset the "old stake" and deposited old stove castings in North-South fence line. The corner point was computed on Survey No. 00-33-B.

MONUMENT AND ACCESSORIES FOUND: None. The corner falls in an irrigation circle.

MONUMENT MARKING DETAIL:

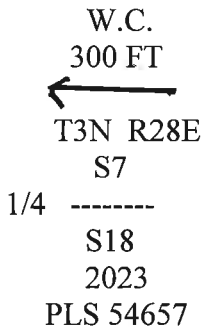

NEW MONUMENT SET:

I computed the corner point on the parallel of latitude and set a Witness Corner monument on the parallel of latitude in a non-farmed area S 89°47'15" E, 300.00 feet from the computed corner point. The witness monument is a 2 1/2" brass cap on 1 1/4 by 30" galvanized iron pipe, with brass cap set flush with the ground. Set a steel fence post 1 foot West of witness monument with witness sign. The witness monument is marked as shown in Monument Marking Detail.

New accessories, (to Witness Corner Monument):

- A 5/8"X24" rebar with blue plastic cap marked "Wells Surveying 54657PLS" bears N 67°37'50" E, 41.97'. Wired bearing object sign to the rebar.
- A 5/8"X24" rebar with blue plastic cap marked "Wells Surveying 54657PLS" bears S 32°40'42" E, 53.76'. Wired bearing object sign to the rebar.
- A 5/8"X24" rebar with blue plastic cap marked "Wells Surveying 54657PLS" bears S 43°11'08" W, 51.11'. Wired bearing object sign to rebar.
- A 5/8"X24" rebar with blue plastic cap marked "Wells Surveying 54657PLS" bears N 12°54'06" W, 383.74', set 6" South of a 4" metal bollard protecting a monitoring well. Wired bearing object sign to the rebar.

Courses to corner accessories are State Plane Grid bearings and distances.

LOCATION AND COMMENTS: Witness corner monument is in an unfarmed area between irrigation circles.

OREGON STATE PLANE COORDINATE, North Zone NAD 83(91), International Feet Units:

N: 760964.10
E: 8492417.16

FIRM: Wells Surveying
P.O. Box 1696
Pendleton, OR 97801

Surveyor's Seal

13N28J-3



24-004-C

RENEWS: 6/30/24