

**OREGON CORNER RESTORATION FORM**

COUNTY: Umatilla. DATE: 02/09/23.

CORNER DESIGNATION: N-15, the North Quarter Corner of Section 22, Township 3 North, Range 28 East, W.M.

PREVIOUS RENEWALS/SURVEYS ETC: Corner was originally established by N.H. Gates under Contract No. 84, dated July 22, 1859. Gates set a post in earth mound. Survey No. H-107-B found an iron pin 18" under ground surface and remonumented with a 2 1/2" by 30" iron pipe. The 2 1/2" iron pipe was recovered and used in Survey No. S-119-B in 1981.

MONUMENT AND ACCESSORIES FOUND: Found 3" O.D. pipe, (2 1/2" I.D.), firmly set, 2" below ground, 1'+/- West of a railroad tie fence corner post. This is a good solid monument. I set a 5/8"x24" rebar with 2" aluminum cap inside of the pipe, stamped as shown in Monument Marking Detail.

**MONUMENT MARKING DETAIL:**

T3N R28E  
1 S15  
4 S22  
2023  
PLS 54657

From the updated corner monument:

**New accessories:**

A 5/8"X24" rebar with blue plastic cap marked "Wells Surveying 54657PLS" bears N 87°46'47" E, 40.56', in East running fence line. Wired bearing object sign to rebar.

A 5/8"X24" rebar with blue plastic cap marked "Wells Surveying 54657PLS" bears N 87°13'00" E, 20.96', in East running fence line. Wired bearing object sign to rebar.

A 5/8"X24" rebar with blue plastic cap marked "Wells Surveying 54657PLS" bears S 01°31'38" E, 39.85', in South running fence line. Wired bearing object sign to rebar.

A 5/8"X24" rebar with blue plastic cap marked "Wells Surveying 54657PLS" bears S 01°46'13" E, 18.31', in South running fence line. Wired bearing object sign to rebar.

Attached Witness Post sign to railroad tie corner post 1'+/- East of monument.

Courses to corner accessories are State Plane Grid bearings and distances.

LOCATION AND COMMENTS: Corner falls 1'+/- West of railroad tie fence corner post with fences South and East, and a old fence post line North without wire.

OREGON STATE PLANE COORDINATE, North Zone NAD 83(91), International Feet Units:

N: 755701.20

E: 8508408.82

FIRM: Wells Surveying  
P.O. Box 1696  
Pendleton, OR 97801

Surveyor's Seal

\3N28N-15

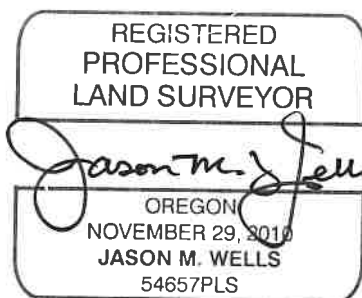

RENEWS: 6:30:24

24-004-C