

OREGON CORNER RESTORATION FORM

COUNTY: Umatilla. DATE: 02/08/23.

CORNER DESIGNATION: N-9, the Northeast Corner of Section 20, Township 3 North, Range 28 East, W.M.

PREVIOUS RENEWALS/SURVEYS ETC: Corner was originally established by N.H. Gates under Contract No. 84, dated July 22, 1859. Gates set a post in earth mound. This corner was reestablished by double proportion measurement on Survey No. 84-56-B and monumented with a brass cap on iron pipe monument.

MONUMENT AND ACCESSORIES FOUND: Found 2 1/2" brass cap on iron pipe 10" below ground level at West edge of gravel field road, stamped as shown in Monument Marking Detail.

MONUMENT MARKING DETAIL:

T3N R28E
S17|S16

S20|S21
1984
PLS 933

MAINTAINED CORNER MONUMENT:

New accessories:

A 5/8"X24" rebar with blue plastic cap marked "Wells Surveying 54657PLS" bears N 76°12'21" E, 21.04', 1'+/- West of UECA pole no. 3N28E160001. Attached bearing object sign to pole. There is an existing Witness Post sign attached to pole.

A pink Deep-1 magnet buried 20" in the ground bears S 38°23'10" E, 43.74'. Buried bearing object sign with magnet.

A blue Deep-1 magnet buried 20" in the ground bears S 44°03'44" W, 31.01'. Buried bearing object sign with magnet.

A orange Deep-1 magnet buried 20" in the ground bears N 41°14'24" W, 25.28'. Buried bearing object sign with magnet.

Courses to corner accessories are State Plane Grid bearings and distances.

LOCATION AND COMMENTS: Corner falls at the West edge of a gravel field road.

OREGON STATE PLANE COORDINATE, North Zone NAD 83(91), International Feet Units:

N: 755679.42
E: 8500456.90

FIRM: Wells Surveying
P.O. Box 1696
Pendleton, OR 97801

Surveyor's Seal

\3N28N-9

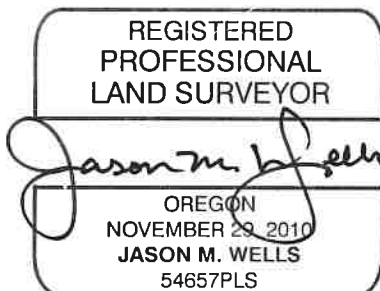

RENEWS: 6.30.24

24-004-C