

**OREGON CORNER RESTORATION FORM**

Section 6  
County Umatilla

Township 3N  
Date: 09/11/09

Range 29E

Corner Designation: 3N29E5

Corner common to sections 5,6,7 and 8, T3NR29E.

_____	Condition Report Only
_____	Not Found
_____X_____	Remonumented
_____	Unrecorded
_____	Surveyed In
_____X_____	Referenced Out

**Previous Renewals / Surveys, etc.**

Originally Surveyed by N.H. Gates in 1859. He set a post in a mound of earth.

Survey Q-511-Ax set a 1 1/2" iron bar.

Survey 98-11-B found Iron bar and set Brass Cap.

Survey Q-53-A found Brass Cap.

Survey S-158-C found Brass Cap.

Survey 83-14-A found iron pipe.

Survey 96-191-B found 1 1/2" Shaft.

Survey 98-237-B found pipe.

D. Haddock found 1" X 3" Steel shaft in 2002.

Edwards found large "L" Iron bar 16" deep, and set a 5/8" Iron rebar at the surface.

**Monuments and Accessories Found: (Condition and Source)**

Found A 5/8" Iron Rebar w/ypc #951.

**Diagram**

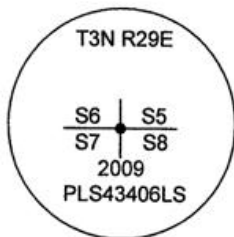

**Sketch**

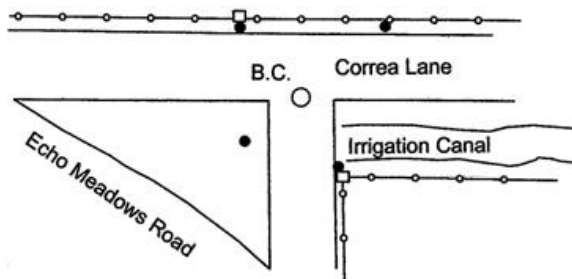

NAD 83/91  
OREGON STATE PLANE NORTH  
INTERNATIONAL FEET

N766602.40  
E8527339.36

LAT - 45° 45' 44.38339" N  
LON - 119° 13' 32.10313" W

**Monument (s) Set (Procedures and Description)**

A 1 1/2" X 14" galvanized Iron pipe with 2 1/2" Brass Cap over the top of Edwards 5/8" Iron rebar, as well as over the found Iron of record.

**References Set:**

- A 30" x 30" Iron rebar w/ypc #43406 lies N 50°30' E, 36.81'.
- A 30" x 30" Iron rebar w/ypc #43406 lies N 47°15' E, 59.99'.
- A 30" x 30" Iron rebar w/ypc #43406 lies S 65°00' W, 20.39'.
- A 30" x 30" Iron rebar w/ypc #43406 lies S 54°45' E, 23.79'.

**Location and Comments**

The corner is at the intersection of Correa Lane and Echo Meadows Road.

**Compass Declination**  
17° E

**Surveyors Seal**

REGISTERED  
PROFESSIONAL  
LAND SURVEYOR

*Robert D. English*  
OREGON  
JANUARY 11, 2005  
ROBERT DOUGLAS ENGLISH  
43406LS

RENEWAL DATE: 12/31/09

**RECEIVED BY:**

Date: 1-11  
Rec'd By: KK  
No. 11-10-R

**Firm / Agency**

Survey One, LLC.  
P.O. Box 382  
Pendleton, OR 97801  
(541) 276-2055