

**OREGON CORNER RESTORATION FORM**

Section 17,18,19,20  
County Umatilla

Township 3N  
Date: 3/8/10

Range 29E

Corner Designation: 3N29N5

Corner common to Sections 17,18,19,20 T3NR29E.

- Condition Report Only
- Not Found
- Remonumented
- Unrecorded
- Surveyed In
- Referenced Out

**Previous Renewals / Surveys, etc.**

Originally Surveyed by Gates in 1859. He set a post in a mound of earth. Staebler set Brass Cap at this location in Survey I-158-B.

**Monuments and Accessories Found: (Condition and Source)**

None. This area has been heavily excavated and graded with the installation of a Center Pivot.

**Diagram**

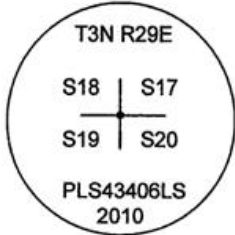

**Sketch**

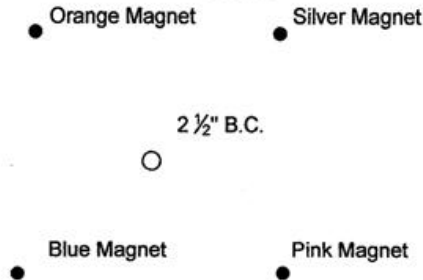

NAD 83/91  
OREGON STATE PLANE NORTH  
INTERNATIONAL FEET

N756099.37  
E8527472.95

LAT - 45° 44' 00.67992" N  
LON - 119° 13' 32.55569" W

**Monument (s) Set (Procedures and Description)**

Set a 1 1/4" x 30" galvanized iron pipe with a 2 1/2" brass cap, buried 23" below surface, stamped as shown above. Reset from ties to Staebler's survey monuments. Note: there is a typo on Don's survey plat. The called distance to the middle of the highway, from the 1/4 corner does not check with the overall distance calls, but the call back from the corner to the highway fits perfectly.

**References Set: "Deep One" magnets by Berntsen.**

- A Silver magnet, 20" deep, lies N 43°40' E, 21.94'.
- A Pink magnet, 20" deep, lies S 20°40' E, 23.78'.
- A Blue magnet, 19" deep, lies S 50° W, 26.31'.
- An Orange magnet, 20" deep, lies N 32° W, 22.70'.

**Location and Comments**

From the intersection of Hwy. 320 and Snow Road, go 0.5 miles West, the corner is North of the House.

**Compass Declination**

17° E

**Surveyors Seal**

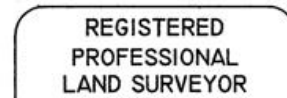

*Robert D. English*  
 OREGON  
 JANUARY 11, 2005  
 ROBERT DOUGLAS ENGLISH  
 43406LS

RENEWAL DATE: 12/31/11

**RECEIVED BY:**

Date: 1-11  
 Rec'd By: KE  
 No. 11-15-R

**Firm / Agency**

Survey One, LLC.  
 P.O. Box 382  
 Pendleton, OR 97801  
 (541) 276-2055