

OREGON CORNER RESTORATION FORM

Section 25,26

Township 3N

Range 29E

County Umatilla

Date: 1/20/09

Corner Designation: 3N29T21

Section corner common to T3NR29E sections 25 and 26.

- Condition Report Only
- Not Found
- Remonumented
- Unrecorded
- Surveyed In
- Referenced Out

Previous Renewals / Surveys, etc.

Originally Surveyed by Gates in 1859. He set a post in a mound of earth.
 In 1992 Wells set a 2 1/2" B.C. in an accepted fence corner.
 In 2002 Haddock found a 2 1/2" B.C.

Monuments and Accessories Found: (Condition and Source)

- A 2 1/2" B.C.
- A 5/8" iron rebar w/ypc lies S 89° 15' W, 69.62'.
- A 5/8" iron rebar w/ypc lies S 89° 15' W, 15.71'.
- A 5/8" iron rebar w/ypc lies S 00° 30' E, 57.67'.
- A 5/8" iron rebar w/ypc lies S 00° 30' E, 26.92'.

Diagram

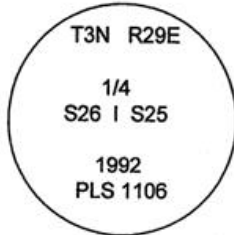

Sketch

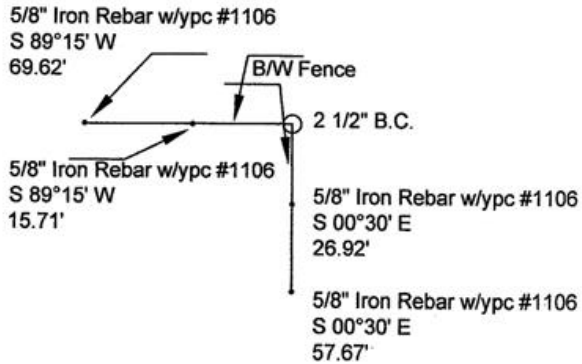

NAD 83/91
 OREGON STATE PLANE NORTH
 INTERNATIONAL FEET

N748513.99
 E8548904.68
 LAT - 45° 42' 42.35280" N LON - 119° 08' 32.24144" W

Monument (s) Set (Procedures and Description)

None.

References Set:

None.

Location and Comments

From Echo school go Southeast on Reith Rd. approx. 3.7 miles. The corner is located on the hill North of the road across the irrigation canal .5 miles.

Compass Declination

17° E

Surveyors Seal

REGISTERED
 PROFESSIONAL
 LAND SURVEYOR

Robert D. English

OREGON
 JANUARY 11, 2005
 ROBERT DOUGLAS ENGLISH
 43406LS

RENEWAL DATE: 12/31/09

RECEIVED BY:

Date: 1-11
 Rec'd By: RS
 No. 11-18-R

Firm / Agency

Survey One, LLC.
 P.O. Box 382
 Pendleton, OR 97801
 (541) 276-2055