

OREGON CORNER RESTORATION FORM

Section 36 Township 3N Range 29E
County Umatilla Date: 05/05/09

Corner Designation: 3N29Z25

Corner common to sections 36, T3NR29E, 31, T3NR30E, 1, T2N29E, 6, T2N30E.

- Condition Report Only
- Not Found
- Remonumented
- Unrecorded
- Surveyed In
- Referenced Out

Previous Renewals / Surveys, etc.

Originally Surveyed by David P. Thompson. He set a post in a mound of earth with pits. S. Haddock set a 1 3/8" x 30" galvanized iron pipe and 2 3/8" Brass cap.

Monuments and Accessories Found: (Condition and Source)

- A 2 3/8" Brass cap approximately 24" below the surface, in good condition.
- A 5/8" Iron rebar w/opc 56295LS lies N 42°50'20" E, 243.14', at the base of a power pole.
- A 5/8" Iron rebar w/opc 56295LS lies N 08°25'55" W, 150.44', at the base of a power meter.
- A 5/8" Iron rebar w/opc 56295LS lies S 61°43'25" E, 27.54', 2 feet below the surface.
- A 5/8" Iron rebar w/opc 56295LS lies S 31°35'12" W, 27.71', 2 feet below the surface.

Diagram

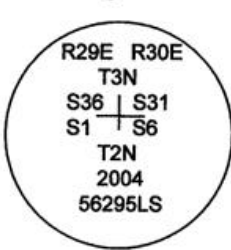

Sketch

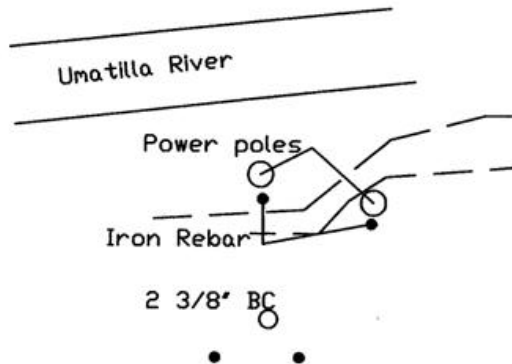

NAD 83/91
OREGON STATE PLANE NORTH
INTERNATIONAL FEET

N740668.57
E8554260.81
LAT - 45° 41' 24.01011" N
LON - 119° 07' 18.65439" W

Monument (s) Set (Procedures and Description)

None

References Set:

None

Location and Comments

The corner is South of the Umatilla river and 1/4 mile west of Nolin Oregon.

Compass Declination
17° E

Surveyors Seal

REGISTERED
PROFESSIONAL
LAND SURVEYOR

Robert Douglas English
OREGON
JANUARY 11, 2005
ROBERT DOUGLAS ENGLISH
43406LS

RECEIVED BY:

Firm / Agency

Date: 5-2-09
Rec'd By: RS
No. 09-83-R

Survey One, LLC.
P.O. Box 382
Pendleton, OR 97801
(541) 276-2055

RENEWAL DATE: 12/31/09