

OREGON CORNER RESTORATION FORM

COUNTY: Umatilla DATE: 04/10/15

CORNER DESIGNATION: The Northwest Corner of Section 4, Township 3 North, Range 31 East, A-9.

PREVIOUS RENEWALS/SURVEYS ETC.: Corner originally surveyed by S. Payne, under Contract No. 100, dated 8/1/1861, notes state: Set charred stake with mound trench and pits as per instructions for corner to secs. 4, 5, 32 & 33. Corner re-established by Dave Krumbein, at fence line intersection on Survey No. M-108-B, dated 1976 and set brass cap monument.

MONUMENT AND ACCESSORIES FOUND: Found 2 1/2" brass cap, in North/South field line 4" above ground stamped as shown in "Monument Marking Detail". A steel fence post with witness post sign 1.0 feet North of monument.

MONUMENT MARKING DETAIL:

T4N R31E
S32|S33
S5|S4
T3N
PLS 933 1976
1976

New Accessories:

- A 5/8" x 24" rebar with a 1 1/4" purple plastic cap stamped "Wells Surveying PLS 54657", in fence line, bears North 02° East, 57.7 feet.
- A 5/8" x 24" rebar with a 1 1/4" purple plastic cap stamped "Wells Surveying PLS 54657", in fence line, bears North 02° East, 24.2 feet.
- A 5/8" x 24" rebar with a 1 1/4" purple plastic cap stamped "Wells Surveying PLS 54657", in fence line, bears South 02° West, 47.7 feet.
- An orange deep-1 magnet, buried 20" in the ground, bears North 53° West, 38.0 feet.
- A wood fence post 1 foot South of corner monument has a witness sign attached.

Buried bearing object tags with magnets. Attached bearing object tags to rebar.

LOCATION AND COMMENTS: Located in a North-South fence line.

OREGON STATE PLANE COORDINATE, North Zone, NAD 83(91), International Feet:

N = 773224.83
E = 8596713.91

FIRM: Wells Surveying
P.O. Box 1696
Pendleton, OR 97801

COMPASS DECLINATION: 18° East

Surveyor's Seal

Witnesses: Jason Wells, PLS
Dean Roy
/3N31A9

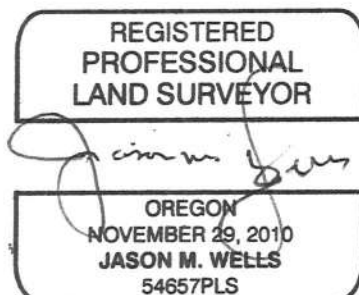

15-052-c

RENEWS: 6-30-16