

OREGON CORNER RESTORATION FORM

COUNTY: Umatilla DATE: 3/27/15

CORNER DESIGNATION: The North One-Quarter Corner of Section 13, Township 3 North, Range 31 East, J-23.

PREVIOUS RENEWALS/SURVEYS ETC.: Corner originally established by D.S. Payne, under Contract No. 100, dated 8/1/1861, notes state: Set charred stake with mound trench and pits as per instrs. for 1/4 sec corner. Corner re-established by John Kimbrell in 1900 survey recorded in Private Survey Book 1, Pag 424 and 425. Kimbrell "set stake".

MONUMENT AND ACCESSORIES FOUND: None.

MONUMENT MARKING DETAIL:

T3N R31E

1 S12

4 S13

2015

PLS 54657

MONUMENT SET:

Held fence corner with fences North and West as beset remaining evidence of the corner position. At a point 1 foot East of fence corner set a 2 3/8" brass cap on a 1 1/4" x 30" galvanized iron pipe, flush with ground for corner, stamped as shown in "Monument Marking Detail".

From which:

A 5/8" x 24" rebar with a 1 1/4" blue plastic cap stamped "Wells Surveying PLS 54657", 2" above ground level, in fence line, bears North 01° East, 65.4 feet.

A 5/8" x 24" rebar with a 1 1/4" blue plastic cap stamped "Wells Surveying PLS 54657", 2" above ground level, bears North 65° East, 42.6 feet.

A 5/8" x 24" rebar with a 1 1/4" blue plastic cap stamped "Wells Surveying PLS 54657", 2" above ground level, bears South 41° East, 51.5 feet.

A 5/8" x 24" rebar with a 1 1/4" blue plastic cap stamped "Wells Surveying PLS 54657", 2" above ground level in fence line, bears North 86° West, 38.0 feet.

Attached bearing object tags to all rebars. Attached witness sign to fence corner post 1 foot West of corner.

LOCATION AND COMMENTS: At a fence corner with fences North and West.

OREGON STATE PLANE COORDINATE, North Zone, NAD 83(91), International Feet:

N = 762678.38

E = 8615344.14

FIRM: Wells Surveying

P.O. Box 1696

Pendleton, OR 97801

COMPASS DECLINATION: 18° East

Surveyor's Seal

Witnesses: Jason Wells, PLS

Dean Roy

/3N31J23

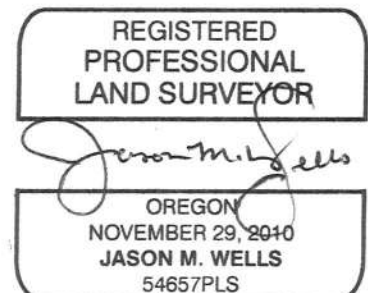

RENEWS: 6-30-16

15-052-c