

OREGON CORNER RESTORATION FORM

COUNTY: Umatilla DATE: 3/27/15

CORNER DESIGNATION: The North One-Quarter Corner of Section 18, Township 3 North, Range 31 East, J-3.

PREVIOUS RENEWALS/SURVEYS ETC.: Corner originally established by D.S. Payne, under Contract No. 100, dated 8/1/1861, notes state: Set charred stake with mound trench and pits as per instrs. for 1/4 sec corner.

MONUMENT AND ACCESSORIES FOUND: None.

MONUMENT MARKING DETAIL:

T4N R31E
1 S7
4 S18
T3N
2015
PLS 54657

MONUMENT SET:

Held intersection of the centerline of Yoakum Road, North-South with a fence projection from the West as best remaining evidence of the original corner location and set a 2 3/8" brass cap on a 1 1/4" x 30" galvanized iron pipe, with top 10" below road surface stamped as shown in "Monument Marking Detail".

From which:

A 3/4" brass washer stamped "PLS 1106" in a UECA power pole #3N31E/075001, 2.0' above ground level, bears North 13° East, 131.0 feet.

A 5/8" x 24" rebar with a 1 1/4" blue plastic cap stamped "Wells Surveying PLS 54657", bears North 23° East, 46.4 feet.

A 5/8" x 24" rebar with a 1 1/4" blue plastic cap stamped "Wells Surveying PLS 54657", bears South 34° East, 27.7 feet.

A 5/8" x 24" rebar with a 1 1/4" blue plastic cap stamped "Wells Surveying PLS 54657", bears South 10° East, 63.1 feet.

Attached bearing object tags to all rebars. Nailed bearing object tag and witness sign to UECA pole.

LOCATION AND COMMENTS: At the intersection of a fence projection from the West with the centerline of Yoakum Road North-South.

OREGON STATE PLANE COORDINATE, North Zone, NAD 83(91), International Feet:

N = 762589.57

E = 8588907.23

FIRM: Wells Surveying

P.O. Box 1696

Pendleton, OR 97801

COMPASS DECLINATION: 18° East

Surveyor's Seal

Witnesses: Jason Wells, PLS

Dean Roy

/3N31J3

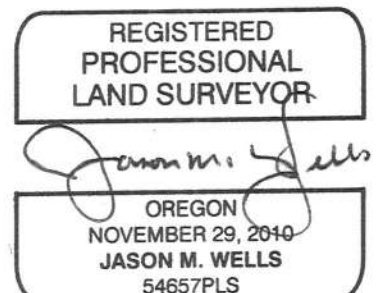

RENEWS: 6-30-16

15-052-c