

**OREGON CORNER RESTORATION FORM**

COUNTY: Umatilla DATE: 04/19/06

CORNER DESIGNATION: 3N31, T-21, The West One-Quarter Corner of Section 25.

PREVIOUS RENEWALS/SURVEYS ETC.: Corner originally established by D.S. Payne, under Contract No. 100, dated August 1, 1861. Record states: Set charred stake with mound, trench and pits as per insts. for 1/4 section corner.

MONUMENT AND ACCESSORIES FOUND: None.

**MONUMENT MARKING DETAIL:**

T3N R31E  
1  
4  
S26 | S25  
2006  
PLS 1106

MONUMENT SET: Re-established corner position by single proportionate measure between the reestablished Northeast and Southeast corners of Section 26. At reestablished corner position, set a 2 3/8" brass cap on 1 1/4" x 30" galvanized iron pipe with cap 15" below ground level. Monument marked as shown in monument marking detail.

From which:

A 5/8" x 24" iron rebar with 1 1/4" red plastic cap marked "OR PLS 1106 WA PLS 17372" bears North 21 1/2° East, 71.8 feet. Set steel fence post by this accessory with witness sign.

A 5/8" x 24" iron rebar with 1 1/4" red plastic cap marked "OR PLS 1106 WA PLS 17372" bears North 76° East, 79.2 feet.

A purple Deep-1 magnet buried 22" below ground level bears South 41° West, 45.3 feet.

An orange Deep-1 magnet buried 22" below ground level bears North 52 1/2° West, 42.0 feet.

Buried bearing object signs with all magnets. Attached bearing object signs to iron rebar accessories.

LOCATION AND COMMENTS: Corner is located in a farmed field at the projection of center lines of Stage Gulch County Road extending North and East.

OREGON STATE PLANE COORDINATE, North Zone, NAD 83(91), International Feet:

N = 749421.52  
E = 8612890.32

FIRM: William R. Wells, PLS  
P.O. Box 1696  
Pendleton, OR 97801

COMPASS DECLINATION: 18° East

Surveyor's Seal

Witnesses: Jason Wells, LSIT

/3N31T21

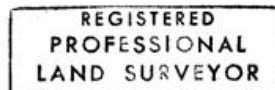

*William R. Wells*

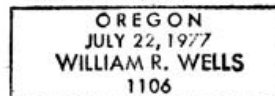

*rehaus 6-30-08*