

OREGON CORNER RESTORATION FORM

COUNTY: Umatilla DATE: 05/31/13

CORNER DESIGNATION: 3N32, C21, The East One-Quarter Corner of Section 2.

PREVIOUS RENEWALS/SURVEYS ETC.: Corner originally established by David Chaplin, under GLO Contract dated September 1864, notes state: Set post for 1/4 Sec. cor in mound of earth with charred stake pits & as per instructions

MONUMENT AND ACCESSORIES FOUND: None.

MONUMENT MARKING DETAIL:

T3N R32E
1/4
S2|S1
2013
PLS 54657

MONUMENT SET: Held the intersection of the centerline of Campbell Road with a old field berm extending East as the best remaining evidence of the original corner location and set a 2 3/8" brass cap on a 1 1/4" x 30" galvanized iron pipe, with cap 12 inches below road surface, stamped as stated in "Monument Marking Detail", from which:

A 5/8" x 24" iron rod with purple plastic cap stamped "Wells Surveying, PLS 54647" in road bank, bears North 33° East, 28.9 feet.

A 5/8" x 24" iron rod with purple plastic cap stamped "Wells Surveying, PLS 54647" in road bank, bears South 33° East, 38.6 feet.

A 5/8" x 24" iron rod with purple plastic cap stamped "Wells Surveying, PLS 54647" in road bank, bears South 19° West, 42.5 feet.

A 5/8" x 24" iron rod with purple plastic cap stamped "Wells Surveying, PLS 54647" in road bank, bears North 51° West, 24.9 feet.

Attached bearing object signs to all accessories.

LOCATION AND COMMENTS: Located in the centerline of Campbell Road with an old field berm East. There is a newer field line extending West.

OREGON STATE PLANE COORDINATE, North Zone, NAD 83(91), International Feet:

N= 771094.54'
E= 8644517.87'

FIRM: Wells Surveying
P.O. Box 1696
Pendleton, OR 97801

COMPASS DECLINATION: 18° East

Surveyor's Seal

Witnesses: Jason Wells, PLS
Dean Roy

\3N32C21

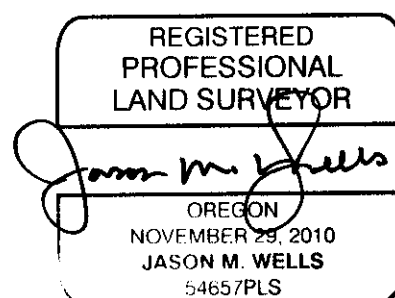

RENEWS: 6-30-14