

**OREGON CORNER RESTORATION FORM**

Section 13 Township 3N Range 36E  
 County Umatilla Date: 06-14-02

Corner Designation: 3N36N21

_____ X _____	Condition Report Only
_____	Not Found
_____	Remonumented
_____ X _____	Unrecorded
_____	Surveyed In
_____	Referenced Out

Previous Renewals / Surveys, etc.

Corner set by Umatilla County Surveyor in PLS933.  
 Location reported by local resident, Mr. Beers.

**Monument and Accessories Found: ( condition and source )**

Found 2 3/8" brass cap stamped as shown in the diagram below northerly of Umatilla County Road ~~900A~~ 900B. The cap is 20" above the surrounding terrain in a stone mound. Did not search for accessories.  
 Top of cap leaning eastward 0.5 feet.

**SKETCH**

**DIAGRAM**

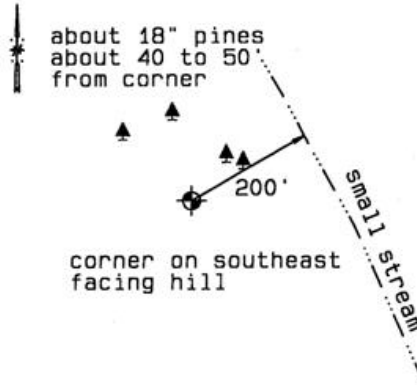
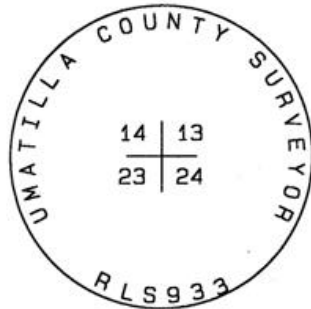

**MONUMENT (S) AND ACCESSORIES SET (Procedures and Description)**

None.

**REFERENCES SET:**

None.

Single Point Solution GPS.	Oregon State Plane Coord. - North Zone
Latitude 45°43'51.72"N	Northing 760461
Longitude 118°16'23.39"W	Easting 8770670
NAD 83 (1991)	Ellipsoidal Height 2330

Location and Comments      Compass Declination      Surveyors Seal

Located northerly of Umatilla River.

REGISTERED  
 PROFESSIONAL  
 LAND SURVEYOR

RECEIVED BY:

Firm / Agency

*David L. Haddock*

Date: 6-05  
 Rec'd By: KK  
 No. 05-122-R

Haddock Surveying  
 P. O. Box 1574  
 Pendleton, OR 97801  
 (541) 276-2174

OREGON  
 JULY 12, 1968  
 DAVID L. HADDOCK  
 852

RENEWS 6-30-05