

CERTIFIED RECORD OF LAND CORNER MONUMENTATION

History of original corner establishment:

Index: Q-7

Center south 1/16 corner, Sec. 20, T.3N., R.36E., W. M

	1	DIAGRAM	1
The original subdivision of Section 20 was performed	1		1
by C. E. Redfield in 1919.	1	1	1
His record indicates a 78.87 chain line was surveyed	1	S ---	1
between the south sixteenth corners of sections 20 and	1	16	1
21 and 19 and 20.	1	C	1
It is assumed that the sixteenth corners were placed	1	1996	8521
at the quarter points along this line.	1	1919 PLS	1
	1		1
	1		1

Description of corner evidence found:

Found a 36" iron pipe with brass cap loose on the ground at the approximate corner position. The cap was a standard Indian Allotment cap stamped with Redfield's standard stamping.

Found the south west and south east sixteenth corner monuments in place.

Description of monument and accessories I established to perpetuate the original location of this corner:

At the midpoint of the line between the two found monuments described above, I set the found loose corner monument 12 inches into the ground. I constructed a stone mound around the monument and stamped my registration number and 1996 on the monument along with the original stamping as shown in the diagram above.

From which:

I set two 5/8 inch by 24 inch steel rods with aluminum cap stamped ORLS 852 and WALS 13922 and B.O. These bearing objects bear N16 18'E, 27.6' and S38 16'E, 45.1'.

This work was done February 13, 1996.

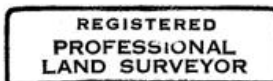

David L. Haddock

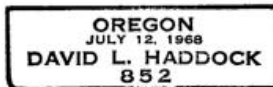

Office of _____ County of _____
State of _____, I hereby certify that the within instrument was filed
in this office for record on the _____ day of _____, 19____.

(COUNTY OFFICIAL) by _____ (DEPUTY)

Form R6-7100-57 (9/71)

RECEIVED BY
Umatilla County Surveyor
Date 2-96
Rec'd by KK
No. 96-24-B