

Form 874-9

U. S. DEPARTMENT OF AGRICULTURE  
FOREST SERVICE

Amatella NATIONAL FOREST

CORNERS OF THE PUBLIC SURVEY

T. 3 N R. 36 E W Mer.

Section Corner common to Sections  
21, 22, 27, and 28

DESCRIPTION OF CORNER

Corner consists of a ?

Dimension above ground ? inches.  
Sketch grooves, letters, figures, or notches, on proper face or edge.

CARDINAL POSITION

DIAGONAL POSITION

N	W	S	E

NW	SW	SE	NE

Mound of \_\_\_\_\_ is located \_\_\_\_\_

Pits are located \_\_\_\_\_

Sketch markings of Bearing Trees (or Rocks) in proper box and fill blanks below, giving bearings from Corner to Trees and Distances in Links.

			T 3 N R 36 E S 27
	BT		BT

Species \_\_\_\_\_ Y.P. \_\_\_\_\_ Y.P.

Diameter \_\_\_\_\_ 2 1/2" \_\_\_\_\_ 1 1/2"

Bearing \_\_\_\_\_ \_\_\_\_\_ \_\_\_\_\_

Distance \_\_\_\_\_ \_\_\_\_\_ \_\_\_\_\_

Do you believe this to be a genuine Land Office Corner? Yes

If not, why? \_\_\_\_\_

John H. Loupton  
Signature.  
Ranger  
Title.

5/12/29  
Date.

T. \_\_\_\_\_ R. \_\_\_\_\_ Mer. \_\_\_\_\_

8-3027

(Make sketch of topography near Corner.)

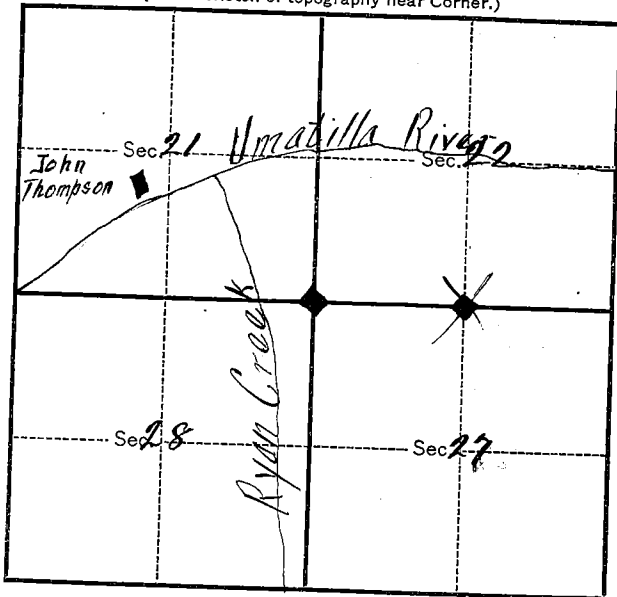

Metal Location Poster is on a \_\_\_\_\_  
tree \_\_\_\_\_ inches diameter, on the \_\_\_\_\_  
side of \_\_\_\_\_  
from which this Corner bears \_\_\_\_\_  
\_\_\_\_\_ chains distant.

Give any further facts which will aid in finding this  
Corner again.

One BT has been felled. Scribing  
gone except B.T. Other BT found  
has been blown over but  
scribing is plain. Corner rock  
was not found. Corner is on  
East side of Ryan Creek on open hillside  
where timber has been felled. About  
1/2 mile south of Umatilla river  
200 yards from Ryan  
creek.

## LAND CORNER RECORD

22 5680-2

1. T 3 N R 36 E S R 13 No. 13 Cor. Sec. Mer. Will. State Oregon (Rectangular) N. F. Umatilla Dist. Pendleton 5

2. Corner Status

	21	

22  
28127

3. Original Description \_\_\_\_\_ Vol. \_\_\_\_\_ Page \_\_\_\_\_ Where Recorded \_\_\_\_\_

4. Description of Corners: Set basalt stone 18x12x8 on steep west hillside for corner to sections 21, 22, 27 & 28, from which:  
Pine 14 inches diameter bears N 54° E 21 links distant  
Pine 14 inches diameter bears S 87° E 61 links distant  
Fir 18 inches diameter bears S 41° W 99 links distant  
Fir 30 inches diameter bears N 45° W 80 links distant

5. Investigation Notes: Using USGS notes and aerial photos as guide, we followed south up Ryan Cr. when we reached first fence crossing in creek botton we then went East along fence line for approximately 5 chains to search area indicated on photo. Found old K. tag on 10" P.P. showing bearing & dist. to sec. corner approximately 1 chain, bearing N 56° W found pine post, 2½" diam 25" above ground, in fair condition. From this post a 7" P.P. with silver tag, bears N 71° E 18 links. We found one dead pine laying on ground assumed to be the 14" P.O.B.T. bearing S 87° E 61 links. There is signs of scribbling on it, but none legible. We chain for other assumed B.T.S. - all were logged off, but old stumps remain.  
In order to preserve corner we erected pile of rock, painted with silver paint, & also the pine post. Since original B.T.S. presumed destroyed, we placed B.T. signs on 10" P.P. bearing N 71° E 34 links from corner B.T. sign on 8" P.P. bears N 36° E 38 links from corner. To help assist in locating sec. corner. These are not original B.T. trees. We also placed K. tag on 10" P.P. that is used as the sub. pt. on photo UM-29-26. Orange ribbon on 5 trees to help in location of sec. corner. Go south up Ryan Cr. when arriving at first fence

6. Signed A.L. Galbraith Title Range Technician Date 5-19-64 cl

7. Photo Identification UM-7-17-64  
 Photo No. Roll 29# 29-26  
 Ident. By: J. Berlin  
A. Galbraith 4-30-64

8. Plane Coordinate Position Data  
 State \_\_\_\_\_ Zone \_\_\_\_\_  
 X \_\_\_\_\_  
 Y \_\_\_\_\_  
 Estab. By \_\_\_\_\_  
 Field Book No. \_\_\_\_\_  
 Where Filed \_\_\_\_\_

9. Evaluation  
 Authentic \_\_\_\_\_  
 Needs Verif.  Monument  No  
 Re-estab.  Survey \_\_\_\_\_  
 Land Status \_\_\_\_\_

PERPETUATION RECORD

10. Monument:

11. Accessories

Field Book \_\_\_\_\_ Page \_\_\_\_\_

12. Set By \_\_\_\_\_ Title \_\_\_\_\_  
 License \_\_\_\_\_ Agency \_\_\_\_\_ Date \_\_\_\_\_

13. Recorded By \_\_\_\_\_ Volume \_\_\_\_\_ Page \_\_\_\_\_  
 (Agency)  
 \_\_\_\_\_  
 (Date) (City) (County) (State)

14. Remarks:

line across the bottom. Then go east along fence for approx. 5 chains to sub. pt. which can be seen from fence line on north side of fence.

Scribbling on the silver tag was: Oren Rogers Lumber Co. Sec. corner is S 70° W 16 links at this time there are 2 B.T.S. Both dead but still legible. I set the corner stake according to field notes.

R-13

Allen L. Piner  
 8-4-56

21	22
28	27

L.D.B.

3 N. R36E