

USDA-FOREST SERVICE

Index
File No. V-1

CORNER RECORD (SEARCH)

(Ref. FSM 7151.4)

Tract or Survey No. _____ Cor. No. _____

T 3N R. ~~37E~~ 37E R.D. _____ County UNION

Merid. WILLAMETTE N.F. UMATILLA State OREGON

CORNER DIAGRAM

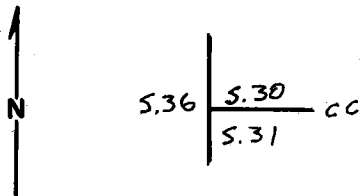

DESCRIBE CORNER MONUMENT FOUND

CORNER STONE WITH 5 NOTCHES ON E. & CC ON EAST, IN A STONE MOUND

DESCRIBE BEARING TREES OR OTHER OFFICIAL ACCESSORIES FOUND

- ① A 22" D.B.H. PONDEROSA PINE, S. 29° E, 45.5', WITH SCRIBES VISIBLE.
- ② STONE MOUND ON ROCK LEDGE, 60' EAST

PHOTO IDENTIFICATION DATA

Photo No. _____
Filed At. _____
Object Ident. _____
Ident. By _____
Signature

PLANE COORDINATE POSITION DATA

State _____ Zone _____
X _____
Y _____
Estab. By _____
Agency

DESCRIBE CORNER LOCATION RELATIVE TO NEAR-BY FEATURES, ALSO HOW TO REACH CORNER

GO TO END OF GRAVEL ON 3128 ROAD, GO NORTH 0.5 MILES ^{TO} OPEN RIDGE ON RT., (BEFOR ROAD TURNS LT. AND DROPS BELOW RIM) PARK HERE, WALK OUT RIDGE AND TAKE RIDGE WHICH RUNS NORTH, GO 1/2 MILE ON RIDGE, COR. IS ON RIDGETOP, CANNOT BE MISSED.

Signature

Clayton J. Mays

Title

LAND SURVEYOR

Division

Headquarters

Date

SEPT 14, 1982

7100-52-(3/68)

CORNER RECORD (PERPETUATION)

MONUMENT: DESCRIBE NEW MONUMENT SET, OR WORK DONE TO PRESERVE EXISTING MONUMENT
SET A 2 1/2" BRASS IN A 2"X30" IRON PIPE, MARKED PER SKETCH,
AND BUILT A LARGER STONE MOUND, BURIED CORNER STONE BY PIPE.

T3N
T36E T.37E.
S.36 | S.30
 | S.31
RPLS 1910
1982

9

ACCESSORIES : DESCRIBE NEW BT'S WITNESS OBJECTS ETC. ESTABLISHED, OR WORK DONE TO PRESERVE EXISTING EVIDENCE

10

Work Done By. C.J. MARTIN Title LAND SURVEYOR Date 9-14-82 State Registration No. _____
or Agency _____

Certified Cor. Record Prepared? (Yes) No Filed At: UMATILLA COUNTY SURV. OFF Date 9-82 11

REMARKS

12

Index

File No. V-1

CORNER RECORD (SEARCH)

(Ref. FSM 7151.4)

Tract or

Cor.

T 3N R. 37E

Survey No. _____

No. _____

Merid. Will

R.D. WALLA WALLA County UMATILLA

N.F. UMATILLA State OREGON

CORNER DIAGRAM

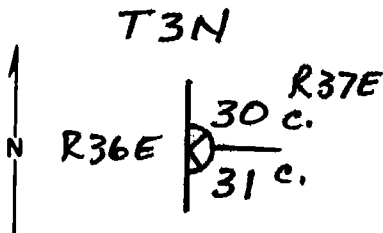

DESCRIBE CORNER MONUMENT FOUND

ORIG. STONE SET IN A MOUND OF STONES & MARKED WITH 5 GROOVES ON NORTH & 1 GROOVE ON SOUTH FACES AND "CC" ON EAST FACE.

DESCRIBE BEARING TREES OR OTHER OFFICIAL ACCESSORIES FOUND

ORIG. 11" PINE IS LIVE & HAS A SINGLE PARTLY HEALED BLAZE WITH SCRIBING VISIBLE. BEARS S29°E, 45.5 ft.

PHOTO IDENTIFICATION DATA

Photo No. _____

Filed At. _____

Object Ident. _____

Ident. By _____

Signature _____

PLANE COORDINATE POSITION DATA

State _____ Zone _____

X _____

Y _____

Estab. By _____

Agency _____

DESCRIBE CORNER LOCATION RELATIVE TO NEAR-BY FEATURES, ALSO HOW TO REACH CORNER

Signature Dennis L. Gaylord

Title

Division

Headquarters

Date

7100-52 (3. 68)

PLS 1636

6-22-82

CORNER RECORD (PERPETUATION)

MONUMENT: DESCRIBE NEW MONUMENT SET, OR WORK DONE TO PRESERVE EXISTING MONUMENT

ACCESSORIES : DESCRIBE NEW BT¹/₄ WITNESS OBJECTS ETC. ESTABLISHED, OR WORK DONE TO PRESERVE EXISTING EVIDENCE

Work Done By _____ Title _____ Date _____ State Registration No. _____
or Agency _____

Certified Cor. Record Prepared ? Yes No Filed At: _____ Date _____

REMARKS

Index File No. _____ T. _____ R. _____ M. _____ Tract or Surv. No. _____ Cor. _____