

U. S. DEPARTMENT OF AGRICULTURE
FOREST SERVICE

Umatilla NATIONAL FOREST

CORNERS OF THE PUBLIC SURVEY

T. 37 R. 38 Mer. 2

Section Corner common to Sections

26, 27, 34, and 35

Corner consists of a Rock (not) in place

State condition Good

Dimensions above ground 12 inches.
Sketch grooves, letters, figures, or notches, on proper face or edge.

CARDINAL POSITION

DIAGONAL POSITION

N	W	S	E

NW	SW	SE	NE

Mound of _____ is located _____

Pits are located _____

Sketch markings of Bearing Trees (or Rocks) in proper box and fill blanks below, giving bearings from Corner to Trees and Distances in Links.

<u>Overgrown</u>	<u>T3N</u> <u>R38E</u> <u>534</u>	<u>Overgrown</u>	<u>Overgrown</u>
	<u>BT</u>		

Species	<u>LP</u>	<u>WF</u>	<u>LP</u>	<u>LP</u>
Diameter	<u>12"</u>	<u>16"</u>	<u>11"</u>	<u>14"</u>
Bearing	<u>N41W</u>	<u>543W</u>	<u>547°E</u>	<u>N16E</u>
Distance	<u>41Lks</u>	<u>40Lks</u>	<u>36Lks</u>	<u>46Lks</u>

Do you believe this to be a genuine Land Office Corner? Yes

If not, why? _____

J. A. Monroe

Signature.

8-12-31

Date.

O. J.

Title.

T. 31N R. 38E W Mer.

8-3027 (Make sketch of topography near Corner.)

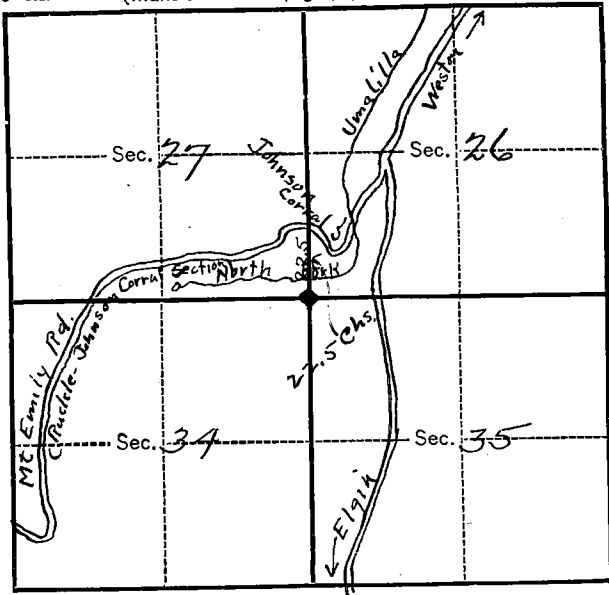

Metal Location Poster is on a LP
tree 11 inches diameter, on the NW
side of Tree
from which this Corner bears N 47° W.
36 Links ~~chains~~ distant.

Give any further facts which will aid in finding this
Corner again.

This section corner is 27 1/2
chains south of the Mt
Emily Road (Puckle Johnson
Corral Section). A section
line board and cruiser
Tag have been placed on
road where section line
crosses. The North Fork of the
Unatilla River is about six
chains north of corner.
L.P. pole Type.

Index
File No. V-17

(Ref. FSM 7151.4)

Survey No. _____

No. _____

T 3N R. 38E

R.D. WALLA WALLA County UNION

Merid. WILLAMETTE

N.F. UMATILLA State OREGON

CORNER DIAGRAM

T3N R38E

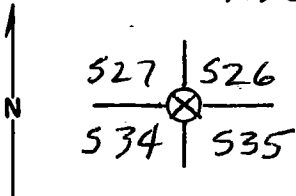

DESCRIBE CORNER MONUMENT FOUND

STONE SOLIDLY SET - NO MARKS VISIBLE.

DESCRIBE BEARING TREES OR OTHER OFFICIAL ACCESSORIES FOUND

ORIG. 3" PINE IS NOW A LIVE 12" LODGEPOLE PINE W/ DOUBLE HEALED BLAZES. BEARS N15°E, 42 LINKS
ORIG. 3" PINE IS NOW A 12" LODGEPOLE PINE SNAG. SCRIBES VISIBLE ON PREVIOUSLY OPENED UPPER BLAZE. BEARS S45°E, 38 LINKS.

ORIG. 8" SPRUCE IS NOW A SHATTERED WHITE FIR STUMP.

DESCRIBE CORNER LOCATION RELATIVE TO NEAR-BY FEATURES, ALSO HOW TO REACH CORNER
SCRIBES VISIBLE. BEARS S45°W, 40 LINKS.

ORIG. 3" PINE IS NOW A LIVE 14" LODGEPOLE PINE W/ DOUBLE HEALED BLAZES. BEARS N50°W, 6 LINKS.
CORNER IS EAST OF HIGHWAY 204 ABOUT 75 FT. & BETWEEN JUNCTION TO SNOW PARK.

→ SEE BACK ←

PHOTO IDENTIFICATION DATA

Photo No. _____

Filed At. _____

Object Ident. _____

Ident. By _____

Signature

PLANE COORDINATE POSITION DATA

State _____ Zone _____

X _____

Y _____

Estab. By _____

Agency

Signature

Title

Division

Headquarters

Date

FS-7100-52 (3/68)

Dennis L. Hayward

PLS 1636

SO

8-26-93

CORNER RECORD (PERPETUATION)

MONUMENT: DESCRIBE NEW MONUMENT SET, OR WORK DONE TO PRESERVE EXISTING MONUMENT

ACCESSORIES: DESCRIBE NEW BT'S WITNESS OBJECTS ETC. ESTABLISHED, OR WORK DONE TO PRESERVE EXISTING EVIDENCE

Work Done By _____ Title _____ Date _____ State Registration No. _____
or Agency _____

Certified Cor. Record Prepared? Yes No Filed At: _____ Date _____

REMARKS

I CHAIN N 30° W, 455 LINKS (ACROSS HIGHWAY) AND FIND THE SHATTERED REMAINS OF TWO WHITE FIRS. THEY HAVE PARTIALLY HEALED BLAZES. MOST, BUT NOT ALL, SCRIBES WERE CHOPPED OUT. ALL BT'S HAVE THE LOWER "BT" BLAZE RIGHT ON THE GROUND.

Index File No. T. R. M. Tract or Surv. No. Cor.

V-17 3N 38E WILL