

USDA-FOREST SERVICE

Index
File No. P-25
T 3S R. 32E
Merid. Willamette

CORNER RECORD (SEARCH)

(Ref. FSM 7151.4)

Tract or Survey No. Sec 24 Cor. No. E 1/4
R.D. Ukiah County Umatilla
N.F. Umatilla State Oregon

CORNER DIAGRAM

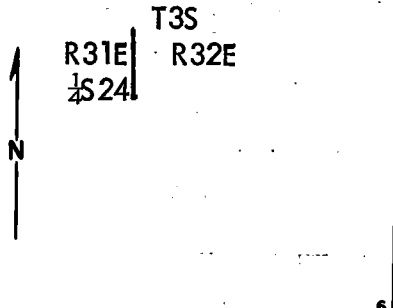

DESCRIBE CORNER MONUMENT FOUND
3" brass cap on 2 1/2" I. pipe in mound of stone.

DESCRIBE BEARING TREES OR OTHER OFFICIAL ACCESSORIES FOUND
A 18" dia Fir Snag bears N20°W 35.5 ft dist (oldBT) open blaze/visible scribing.
A 12" dia Fir bears N73°W 30.3 ft dist tagg S73°E46 lk dist-recent blaze.
A 12" dia R.Fir bears S29°W13.0 ft dist tagg N29 1/2°E 20 lk dist-rec.blaze.

PHOTO IDENTIFICATION DATA

Photo No. 616140 780-7
Filed At. Umatilla Nat. Forest
Object Ident. Trees
Ident. By _____
Signature

DESCRIBE CORNER LOCATION RELATIVE TO NEAR-BY FEATURES, ALSO HOW TO REACH CORNER
Yellow Jacket Road to road #5415, then East to the second cattleguard, then 50 ft East of cattleguard turn North on Skid Road, then North approx. 600 ft to closing corner of S20 and S29 then follow fence from corner to the North approximately 1,900 ft to the corner, which is on the South edge of Bridge Creek Canyon.

PLANE COORDINATE POSITION DATA

State _____ Zone _____
X _____
Y _____
Estab. By _____
Agency

Signature William R. Wells Title PLS 1106 Division _____ Headquarters _____ Date September 27, 1982
7100-52-(3/68)

CORNER RECORD (PERPETUATION)

MONUMENT: DESCRIBE NEW MONUMENT SET, OR WORK DONE TO PRESERVE EXISTING MONUMENT

Set steel fence posts with 54-4 and 2 signs 5 ft North of corner and post with 54-2 sign 4 ft South.
Standard BLM cap.

Cap marked:

T3S
R32E | R32E
1/4 S24 |
1978

ACCESSORIES : DESCRIBE NEW BT'S WITNESS OBJECTS ETC. ESTABLISHED, OR WORK DONE TO PRESERVE EXISTING EVIDENCE

Painted blaze faces and 6" band around bearing trees, red. Tagged trees with 54-3 and 4 signs where needed.

Work Done By W.R. Wells Title Surveyor Date 9/27/82 State Registration No. PLS 1106
or Agency

Certified Cor. Record Prepared ? Yes No Filed At: Umatilla County Surveyor Office Date

REMARKS

Witnessed by: D.L. Kaufman PLS

Index File No.
P-25

T. 3S

R. 32E

M. W.M.

Tract or Surv. No.

Sec 27

Cor.

E 1/4

Index File No. P-25
 T 3 S R, 31 E
 Merid. Willamette

CORNER RECORD (SEARCH)

(Ref. FSM 7151.4)

Tract or Survey No. _____ Cor. No. _____

P-25

R.D. Ukiah County Umatilla
 N.F. Umatilla State Oregon

CORNER DIAGRAM

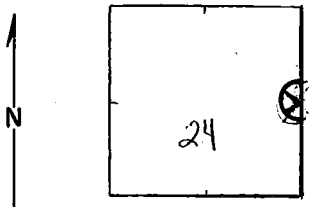

DESCRIBE CORNER MONUMENT FOUND

Material: Stone mound

Markings: None visible

DESCRIBE BEARING TREES OR OTHER OFFICIAL ACCESSORIES FOUND

An 18" fir snag about 25' high bears approximately N 20° W, approximately 30 feet. Faint scribing visible on SE face. No evidence of NE B.T. Fences run north-south and west.

PHOTO IDENTIFICATION DATA

Photo No. _____
 Filed At. _____
 Object Ident. _____
 Ident. By _____
Signature

DESCRIBE CORNER LOCATION RELATIVE TO NEAR-BY FEATURES, ALSO HOW TO REACH CORNER

PLANE COORDINATE POSITION DATA

State _____ Zone _____
 X _____
 Y _____
 Estab. By _____
Agency

Signature
 Tom Hollamon

Title
 Eng. Tech.

Division

Headquarters

Date
 10/8/75

7100-52 (3/68)

CORNER RECORD (PERPETUATION)

MONUMENT: DESCRIBE NEW MONUMENT SET, OR WORK DONE TO PRESERVE EXISTING MONUMENT

9

ACCESSORIES : DESCRIBE NEW BT'S WITNESS OBJECTS ETC. ESTABLISHED, OR WORK DONE TO PRESERVE EXISTING EVIDENCE

I placed a B.T. tag on the B.T. snag. Also placed a location poster on a 3" fir at approximate corner location in fence corner.

10

Work Done By _____ Title _____ Date _____ State Registration No. or Agency _____

Certified Cor. Record Prepared ? Yes No Filed At: _____ Date _____

11

REMARKS

12

Index File No. T. R. M. Tract or Surv. No. Cor. 13