

R-1A

History of original corner establishment:

None

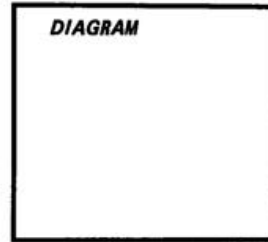

Description of corner evidence found:

None

Description of monument and accessories I established to perpetuate the original location of this corner:

Set 2 1/2" diameter Brass cap on 1 1/2" x 30" Galvanized Pipe 24" in the ground stamped:

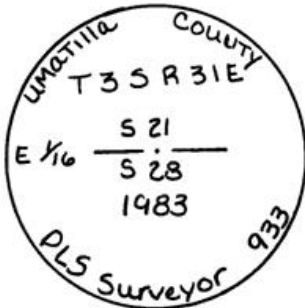

Bearing Trees:

A 9" Douglas Fir bears due South 8.0 feet scribed 1/16 S 28 BT.

A 12" Douglas Fir bears North 80°30' East a distance of 23.5 feet scribed 1/16 S 21 BT.

B.T.'s were painted red with "Bearing Tree" and "Witness Post" signs nailed to the trees.

Trees also have Brass Washers nailed below the B.T. scribe stamped:



Office of County Surveyor County of Umatilla
State of Oregon I hereby certify that the within instrument was filed in this office
for record on the 20th day of April 19 83
Dwain A. Drumblin by Beth L. Cochran
(COUNTY OFFICIAL) (DEPUTY)

R-12