

CERTIFIED RECORD OF LAND CORNER MONUMENTATION

History of original corner establishment:

Index: R-21

Corner Sec. 23, 24, 25 & 26, T.3S., R.31E., W.M.
Original corner was set by George S. Pershin under
Contract Number 319 in 1879.

His record reads:

Set a stone 22x12x6 in mound of stone for corner to
Sec's 23, 24, 25, and 26, from which

A pine 20" ins. diam. bears N 80° E, 168 lks. dist.

A pine 20" ins. diam. bears S 3° E, 72 lks. dist.

A pine 30" ins. diam. bears S 76° W, 113 lks. dist.

A pine 32" ins. diam. bears N 3° W, 40 lks. dist.

DIAGRAM

T3SR31E

S23|S24

S26|S25

1995

PLS 852

Description of corner evidence found:

Found the original stone lying loose on the ground with tracks from a logging tractor over the top of the mound. A steel fence post also was loose along side the mound. A pine stump with the BT scribe plainly visible was N 22°54' W, 26.2' from the mound. A 27" ponderosa pine with a healed blaze lies S 3° E from the mound. A pine stump, cut below the level of the BT scribe on the other original trees found, lies S 78°10' W, 73.5' from the mound

Description of monument and accessories I established to perpetuate the original location of this corner:

The bearings were based on the record bearings of the existing witness trees.

I set a 2 1/2" brass disk on a 30" galvanized Iron Pipe on bedrock 1 foot below the surface of the ground at the record distances from the existing bearing objects. A mound of stone was erected around the monument and the monument marked as in the diagram above. The original stone was buried along side.

I set the following new witness trees:

A 16" dbh Ponderosa Pine bears N46°27'W, 98.9' scribed T3SR31ES23BT.

A 15" dbh Ponderosa Pine bears N43°41'E, 31.7' scribed T3SR31ES24BT.

A 8.6" dbh Ponderosa Pine bears S59°11'W, 25.2' scribed T3SR31ES26BT.

A Brass washer stamped ORLS 852 and WAL5 13922 is nailed between the letters B and T on the new trees. All the BT's have BT signs attached. Painted 2, 1" red bands around all the trees and painted the scribe blazes red. Placed a 6' steel post by the mound with a Umatilla County Land Survey Monument sign on it.

This work was done October 17, 1995.

Office of Survey Dept. County of Umatilla
State of OREGON, I hereby certify that the within instrument was filed
in this office for record on the 23rd day of October, 1995.

(COUNTY OFFICIAL)

(DEPUTY)

Form R6-7100-57 (9/71)

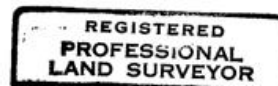

David L. Haddock



RECEIVED BY
Umatilla County Surveyor
Date 10-95
Received by KK
No. 95-182-B