

CERTIFIED RECORD OF LAND CORNER MONUMENTATION

X-16

History of original corner establishment:

None

No record of corner establishment found in County Records.

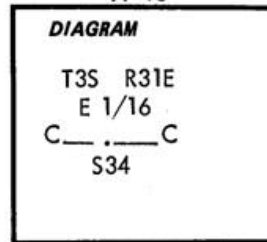

Description of corner evidence found:

None.

Description of monument and accessories I established to perpetuate the original location of this corner:

Set 2 1/2" brass cap on 2 1/2" x 30" I. pipe 18" in ground with mound of stone to cap from which:

- A 7" dia Fir bears S77°W 81.2 ft dist marked: CE 1/16 S34 BT.
- A 7" dia Fir bears N26°W 75.7 ft dist marked: CE 1/16 S34 BT.

Blaze faces and 6" bands around bearing trees are painted red. Trees tagged with 54 - 3 & 9 signs. BTs have a lower blaze, scribed BT, with brass washer stamped PLS 1106 nailed flush.

Set steel fence post with 54- 2 & 9 signs attached, North of corner.

Used Steel tape and magnetic compass 19 3/4° East declination. Measured to center of BTs.

Corner monumented on October 25, 1982.

Cap marked:

Witnessed by: Robert D. English P.C.
D. L. Kaufman PLS

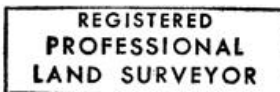
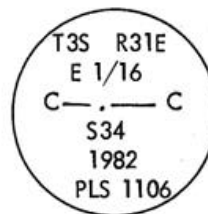

William R. Wells

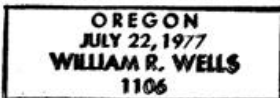

Office of..... County Surveyor..... County of..... Umatilla
Oregon..... I hereby certify that the within instrument was filed in this office
for record on the 15th day of December, 1982
Daniel H. Krumbein by *Betty L. Slade*
(COUNTY OFFICIAL) (DEPUTY)

Form R6-7100-57 (9/71)

RECEIVED BY
Umatilla County Surveyor ☆ GPO-798-276
Date _____
Rec'd by _____
No. 82-138-B