

USDA-FOREST SERVICE

Index

File No. Z-15

CORNER RECORD (SEARCH)

(Ref: FSM 7151.4)

Tract or

Survey No. Sec 34 Cor. No. S 1/4

T 3S R. 31E

R.D. Ukiah County Umatilla

Merid. Willamette

N.F. Umatilla State Oregon

CORNER DIAGRAM

T3S R31E

S34

1/4



DESCRIBE CORNER MONUMENT FOUND

A 16" x 10" x 5" stone in mound of stone marked 1/4.

DESCRIBE BEARING TREES OR OTHER OFFICIAL ACCESSORIES FOUND

None.

PHOTO IDENTIFICATION DATA

Photo No. 616140 380-4

Filed At Umatilla Nat. Forest

Object Ident. Trees

Ident. By _____
Signature

PLANE COORDINATE POSITION DATA

State _____ Zone _____

X _____

Y _____

Estab. By _____
Agency

DESCRIBE CORNER LOCATION RELATIVE TO NEAR-BY FEATURES, ALSO HOW TO REACH CORNER

Road #5420 to road #5412-100, then West on road #5412-100 approx. 1.4 miles to fork headed South through gate, then South through gate and W on West fork of road approx. 0.5 mile, then South on South fork on road through clearing to corner in sparse timber 30 ft East of road and 81 ft S82°W from fence corner fences go South and West.

Signature
William R. Wells

Title
PLS 1106

Division

Headquarters

Date

October 7, 1982

7100-52 (3/68)

CORNER RECORD (PERPETUATION)

MONUMENT : DESCRIBE NEW MONUMENT SET, OR WORK DONE TO PRESERVE EXISTING MONUMENT

Set 2 1/2" brass cap on 2 1/2" x 30" l. pipe 20" in ground with mound of stone. Buried stone monument upside down alongside monument.
Set steel fence post with 54-4 sign attached East of corner. Cap marked:

T3S R31E
1/4 S34
T4S R31E
S2
1982
PLS 1106

ACCESSORIES : DESCRIBE NEW BT'S WITNESS OBJECTS ETC. ESTABLISHED, OR WORK DONE TO PRESERVE EXISTING EVIDENCE

A 18" dia P. Pine bears N81°W 85.5 ft dist marked: 1/4 S34 BT.
A 18" dia P. Pine bears N33 1/2°E 23.7 ft dist marked: 1/4 S34 BT.
Blaze faces and 6" band around bearing trees are painted red. Tagged trees with 54- 3 & 4 signs.
Each new BT has a lower blaze, scribed BT, with brass washer stamped PLS 1106 nailed flush.

Work Done By W.R. Wells Title Surveyor Date 10/7/82 State Registration No. PLS 1106
or Agency _____

Certified Cor. Record Prepared ? Yes No _____ Filed At: Umatilla County Surveyor Office Date _____

REMARKS

Witnessed by: Leslie E. Wilson

USDA-FOREST SERVICE

Index

File No. Z-15

CORNER RECORD (SEARCH)

(Ref. FSM 7151.4)

Tract or

Survey No. _____

Cor.

No. _____

T 35 R. 31E

R.D. UKIAH County UMATILLA

Merid. WILL

N.F. UMATILLA State OREGON

CORNER DIAGRAM

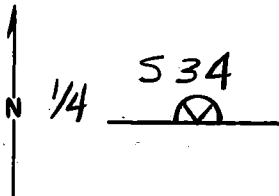

DESCRIBE CORNER MONUMENT FOUND

ORIGINAL CORNER STONE IN A MOUND OF STONES & MARKED "1/4"

2

DESCRIBE BEARING TREES OR OTHER OFFICIAL ACCESSORIES FOUND

ORIGINAL 20" PINE IS NOW A BADLY DECAYED PONDEROSA PINE STUMP (SAWN). NO MARKS ARE VISIBLE. STUMP BEARS N11°E, 172± FT.

3

PHOTO IDENTIFICATION DATA

Photo No. _____

Filed At. _____

Object Ident. _____

Ident. By _____

Signature

7

PLANE COORDINATE POSITION DATA

State _____ Zone _____

X _____

Y _____

Estab. By _____

Agency

8

DESCRIBE CORNER LOCATION RELATIVE TO NEAR-BY FEATURES, ALSO HOW TO REACH CORNER

CORNER IS 35' EAST OF A PRIMITIVE N-S ROAD & 75' EAST OF A FENCE CORNER - FENCES RUN SOUTH & WEST. I PLACED A LOCATION POSTER ON A 12" PINE S62°E, 20' FROM CORNER STONE.

4

Signature

Title

Division

Headquarters

Date

Dennis J. Gaylord

PLS 1636

3-10-81

7100-52-(3/68)

5

CORNER RECORD (PERPETUATION)

MONUMENT : DESCRIBE NEW MONUMENT SET, OR WORK DONE TO PRESERVE EXISTING MONUMENT

9

ACCESSORIES : DESCRIBE NEW BT's WITNESS OBJECTS ETC. ESTABLISHED, OR WORK DONE TO PRESERVE EXISTING EVIDENCE

10

Work Done By _____ Title _____ Date _____ State Registration No. or Agency _____

Certified Cor. Record Prepared ? Yes No Filed At: _____ Date _____

11

REMARKS

12

Index File No. T. R. M. Tract or Surv. No. Cor. _____

13