

CERTIFIED RECORD OF LAND CORNER MONUMENTATION

History of original corner establishment:

Corner originally established by George S. Pershin under GLO contract number 430, dated March 23, 1882. Surveyor General record states:

At point of intersection, I set a basalt stone 14x10x5 ins 10 ins in the ground on West slope for cor to Townships 3 S, Ranges 32 & 33 East marked with 6 notches on E, S and W edges.
 A Fir 12 ins di. brs. S38°W 30 lks dist marked T3S R32E S1 BT
 A Fir 5 ins di. brs. S53°E 38 lks dist marked T3S R33E S6 BT

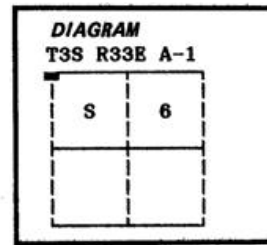

No record of subsequent monumentation found in Umatilla County survey records.

Description of corner evidence found:

Found stone 16x12x6 inches marked with 6 notches on 2 sides and 5 notches on another side of the stone, laying in a small mound of stone.

Found a 18 inch diameter Douglas Fir S53°E, 38 lks with blaze evident. This tree was opened on at least 2 previous occasions, destroying any scribing if this was the original BT. I cannot positively identify it as the original BT.

Found no evidence of the original Southwest BT.

See survey dated September, 1988.

Description of monument and accessories I established to perpetuate the

original location of this corner: At the true point of intersection, determined by survey to be South 0°05'57" East, 44.13 feet from the found closing corner stone, I set a 2 1/2" x 30" aluminum pipe with aluminum cap marked as shown, 28 inches in the ground, from which:

New BTs:

A 13 inch diameter Lodgepole Pine bears S27°E, 29.91 feet marked T3S R33E S6 CC BT
 A 11 inch diameter Douglas Fir bears S78°W, 22.54 feet marked T3S R32E S1 CC BT

Raised a small mound of stone around monument.
 Marked "AM" on original stone and buried it East and alongside of monument.

Painted a 6 inch red band around all BTs and attached bearing tree and land survey monument signs.
 Set a steel fencepost 2.90 feet East with land survey monument sign attached.

I hereby certify that the above corner point was perpetuated as hereon described on September 1, 1988.

Witnesses: Jeff Petersen and Rick Robinson

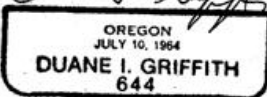
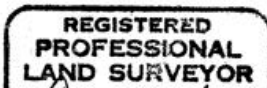
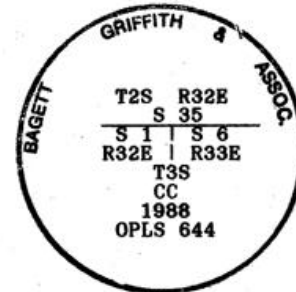

I used a steel tape and magnetic compass in the establishment of new accessories. I used 17° East magnetic declination and the distances are to a 50d spike driven in the right side of the root crown. I attached a brass washer marked OPLS 644 to the BT blaze.

Office of Sussex County of Umatilla
 State of OR, I hereby certify that the within instrument was filed in this office for record on the 27th day of September, 1988
David H. Kumbren by Kathleen K. Hensley
 (COUNTY OFFICIAL) (DEPUTY)

RECEIVED BY

Form R6-7100-57 (9/71)

Umatilla County Surveyor ☆ U.S. GOVERNMENT PRINTING OFFICE - 1983-793-276

Date 9-88
 Rec'd by KH
 No. 88-92-C