

# RECORD OF LAND CORNER MONUMENTATION

SOUTHWEST CORNER SECTION 22, T. 3 S., R. 32 E., W.M.

**ORIGINALLY ESTABLISHED BY:** George S. Pershin, U.S. Deputy Surveyor

**CONTRACT NUMBER:** 430

**CONTRACT DATE:** March 23, 1882

**SUBSEQUENT SURVEYS:**

- ▶ 1977 Remonumentation by Craig L. Wanless, BLM Cadastral Surveyor, under special instructions dated May 3, 1957, Group No. 350, approved May 6, 1957.
- ▶ 1982 Remonumentation by William R. Wells, PLS #1106, recorded December 15, 1982, as Survey No. 82-136-B in the office of the Umatilla County Surveyor.

|    |    |    |    |
|----|----|----|----|
| 16 | 15 | 15 | 14 |
| 21 | 22 |    | 22 |
|    |    |    |    |
|    |    |    |    |
| 21 | 22 |    | 22 |
| 28 | 27 |    | 27 |
|    |    |    |    |
|    |    |    |    |
|    |    |    |    |
|    |    |    |    |

**ORIGINAL DESCRIPTION:** Set a post 4 ft long, 4 in. square 2 ft in ground on steep N. Slope for cor. to Sec. 21, 22, 27 and 28 (descend 80 ft) marked with 2 notches on S. and 3 notches on E edges; also T3S. S. 22 on N.E. R. 32 E S. 27 on S.E. S 28 on SW. and S. 21 on N.W.

- A Tamarack 12 ins di. brs. N.45°E, 29 lks. dist marked T3S. R.32E S.22 B.T.
- A Fir 9 ins di. brs. S.72°E, 41 lks dist marked T3S. R.32E. S.27 B.T.
- A Tamarack 7 ins di. brs. S.55°W, 18 lks dist marked T3S. R.32E. S.28 B.T.
- A Pine 5 ins di. brs. N.56°W, 13 lks dist marked T3S. R.32E. S.21 B.T.

**1977 DESCRIPTION:** The cor. of secs. 21, 22, 27, and 28, determined at record bearing and distance from the only remaining original bearing tree:

- A larch, 16 ins. diam., bears S. 55° W., 18 lks dist., with healed blaze.
- At the corner point Set an iron post, 28 ins. long, 2 1/2 ins. diam., 22 ins. in the ground, and in a mound of stone, 2 ft. base, to top, with brass cap mkd. (diagram shown) from which new bearing trees
- A grand fir, 9 ins. diam., bears N. 56° E., 32 lks. dist., mkd. T3S R32E S22 BT.
- A grand fir, 10 ins. diam., bears S. 60° E., 42 lks. dist., mkd. T3S R32E S27 BT.
- A grand fir, 9 ins. diam., bears N. 35° W., 29 1/2 lks. dist., mkd. T3S R32E S21 BT.

**1982 DESCRIPTION:** Mr. Wells found the BLM brass cap and all four bearing trees. He set a steel fence post with 54-4 sign on the section line near the corner.

**EVIDENCE FOUND:** Found a 2 1/2" galvanized iron pipe with 3 1/4" BLM brass cap marked as shown below, projecting 1" above ground with no visible mound of stone, with green T-post south and alongside, with USFS sign 54-4 attached. From the found monument, a western larch 19" dbh, bears S.55°W., 11.0 ft. with healed blaze (GLO bearing tree) All other bearing trees of record are dead and down.

**DESCRIPTION OF MONUMENTS AND ACCESSORIES SET AND METHODS USED:**

I accept the found BLM monument as a perpetuation of the original corner.

CORNER MONUMENT  
MARKED:

From which, **I SCRIBE NEW BEARING TREES:**

- ▶ A white fir, 10" dbh, bears N.51°E., 20.78 ft. marked *T3SR32ES22* in upper blaze and *BT* in lower blaze
- ▶ A white fir, 8" dbh, bears S.77°E., 23.18 ft. marked *X* in upper blaze and *BT* in lower blaze
- ▶ A white fir, 14" dbh, bears N.74°W., 23.3 ft. marked *T3SR32ES21* in upper blaze and *BT* in lower blaze

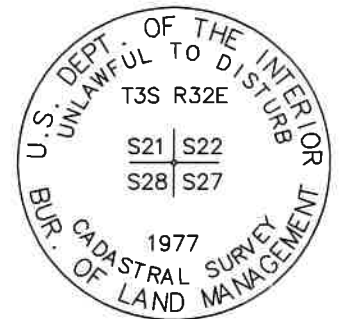

Painted a 6 inch red band around each bearing tree, and also painted blazes red and attached USFS 54-3 and 54-9 signs. Distances to new BT's measured with a handheld EDM to a Mag Spike driven in the side-center at the root crown of each tree, with an attached 1 1/2" aluminum washer stamped *PLS 69454*. Bearings measured with a magnetic compass with 14° east declination.

**RESTORATION BY, STAMP AND DATE:**

Work completed May 15, 2024 by:

Jason L. Hatfield, PLS

USDA FOREST SERVICE  
NORTHEAST OREGON LAND ZONE  
1550 Dewey Avenue, Suite A  
Baker City, OR 97814  
(541) 523-1283



EXPIRES: 6/30/2025

24-078-6