

USDA-FOREST SERVICE

Index

File No. Z-(1-3)

CORNER RECORD (SEARCH)

(Ref. FSM 7151.4)

Tract or Survey No. \_\_\_\_\_

Cor. Closing No. AM

T 2S R. 33E

R.D. Ukiah County Umatilla

Merid. Willamette

N.F. Umatilla State Oregon

CORNER DIAGRAM

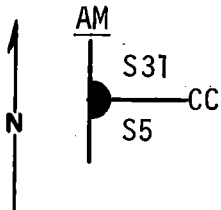

DESCRIBE CORNER MONUMENT FOUND

At corner position found 18"x12"x10" stone 9" in ground with "CC" on east face & 6 notches on north & south face.

DESCRIBE BEARING TREES OR OTHER OFFICIAL ACCESSORIES FOUND

Found Tamarack 22" dia. with small opening in blaze and parts of scribing visible "3". Found remains of rotted Fir stump with visible scribing "R32E S36".

PHOTO IDENTIFICATION DATA

Photo No. \_\_\_\_\_

Filed At. \_\_\_\_\_

Object Ident. \_\_\_\_\_

Ident. By \_\_\_\_\_

*Signature*

This closing corner is not at the True intersection position. The True closing corner position is monumented

PLANE COORDINATE POSITION DATA

State \_\_\_\_\_ Zone \_\_\_\_\_

X \_\_\_\_\_

Y \_\_\_\_\_

Estab. By \_\_\_\_\_

*Agency*

*Signature*

Title

Division

Headquarters

Date

ORLS

1294

9-77

7100-52-(3/68)

**CORNER RECORD (PERPETUATION)**

**MONUMENT: DESCRIBE NEW MONUMENT SET, OR WORK DONE TO PRESERVE EXISTING MONUMENT**

In place of stone set 2 1/2"x30" galvanized pipe with brass cap stamped:

Set pipe 24" in ground with mound of stone to cap and original stone buried alongside.

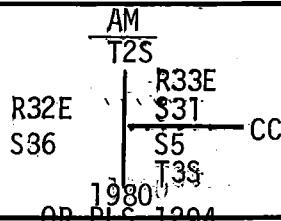

**ACCESSORIES : DESCRIBE NEW BT'S WITNESS OBJECTS ETC. ESTABLISHED, OR WORK DONE TO PRESERVE EXISTING EVIDENCE**

Bearing Trees: Old BT: A Tamarack 22" dia. bears N45°E 1215 ft with visible scribing "3".

New BT: A Douglas Fir 12" dia. bears N66°E 26.5 ft, scribed T2S R33E S31 CC BT.

A White Fir 6" dia. bears N14°E, 10.6 ft, scribed T2S R33E S31 CC BT.

Attached 54-3 & 54-4 signs to all BT's. Attached brass washer stamped LS1294 to foot blaze of new BT's. Painted blazes and 6" band around both BT's red. Attached 54-4 sign to metal post 5' north of corner. The 54-3 signs have AM marked on them.

Work Done By R. C. Orton Title Party Chief Date 7-31-80 State Registration No. \_\_\_\_\_ or Agency \_\_\_\_\_ 10

Certified Cor. Record Prepared ? (Yes ) No Filed At: \_\_\_\_\_ Date \_\_\_\_\_ 11

Witnesses: R. Orton  
L. Huntsman  
D. Allen

REMARKS

Index File No. Z-1 T. 25 R. 33E M. \_\_\_\_\_ Tract or Surv. No. \_\_\_\_\_ Cor. \_\_\_\_\_ 12  
13

Index  
File No. Z-(1-3)

**CORNER RECORD (SEARCH)**  
(Ref. FSM 7151.4)

Tract or Survey No. \_\_\_\_\_  
Cor. No. \_\_\_\_\_ True Closing

T 2S R. 33E

R.D. Ukiah County Umatilla

Merid. Willamette

N.F. Umatilla State Oregon

**CORNER DIAGRAM**

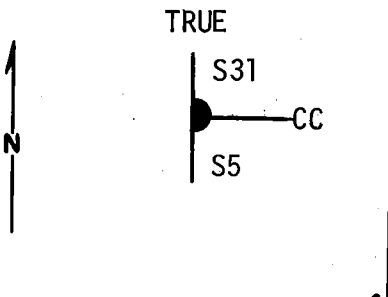

**DESCRIBE CORNER MONUMENT FOUND**  
At corner position found 18"x12"x10" stone 9" in ground with "CC" on east face & 6 notches on north & south face. This closing corner is not at the true intersection position, this corner was monumented and stamped AM for amended corner.

**DESCRIBE BEARING TREES OR OTHER OFFICIAL ACCESSORIES FOUND**  
Found Tamarack 22" dia. with small opening in blaze and parts of scribing visible "3". Found remains of rotted fir stump with visible scribing "R32E S36".

**PHOTO IDENTIFICATION DATA**

Photo No. \_\_\_\_\_  
Filed At. \_\_\_\_\_  
Object Ident. \_\_\_\_\_  
Ident. By \_\_\_\_\_  
*Signature*

**DESCRIBE CORNER LOCATION RELATIVE TO NEAR-BY FEATURES; ALSO HOW TO REACH CORNER**  
Corner falls on N. slope approx. 75' west of clearing.

**PLANE COORDINATE POSITION DATA**

State \_\_\_\_\_ Zone \_\_\_\_\_  
X \_\_\_\_\_  
Y \_\_\_\_\_  
Estab. By \_\_\_\_\_  
*Agency*

*Signature* \_\_\_\_\_ Title \_\_\_\_\_ Division ORLS Headquarters 1294 Date 9-77  
7100-52-(3-68)

**CORNER RECORD (PERPETUATION)**

**MONUMENT: DESCRIBE NEW MONUMENT SET, OR WORK DONE TO PRESERVE EXISTING MONUMENT**

At True intersection point set 2 1/2"x30" galvanized pipe with brass cap stamped:

Set pipe 24" in ground with mound of stone to cap.

TRUE T2S  
 R32E | R33E  
 | S31  
 | S5 — CC  
 S36 | T3S  
 1980  
 OR PLS 1294

**ACCESSORIES : DESCRIBE NEW BT'S WITNESS OBJECTS ETC. ESTABLISHED, OR WORK DONE TO PRESERVE EXISTING EVIDENCE**

Bearing Trees:

Old: A Tamarack 22" dia. bears N68°E 22.1 ft, with visible scribing "3".

New: A 6" White Fir bears N53°E 17.0 ft, scribed T2S R33E S31 CC BT.

A 12" dia. Douglas Fir bears N71°E 37.2 ft, scribed T2S R33E S31 CC BT.

Attached 54-3 & 54-4 signs to all BT's. Attached brass washer stamped LS1294 to foot blaze of new BT's. Painted blazes and 6" band around all BT's. The 54-3 signs have TRUE marked on them. Attached 54-4 sign to metal post 5' east of corner.

Work Done By R. C. Orton Title Party Chief Date 8-20-80 State Registration No. \_\_\_\_\_ or Agency \_\_\_\_\_

Certified Cor. Record Prepared ? (Yes)  No  Filed At: \_\_\_\_\_ Date \_\_\_\_\_

Witnesses: R. Orton  
 G. Wagoner  
 G. Lester  
 J. Anderson

REMARKS

Index File No. T. R. M. Tract or Surv. No. Cor.

2-1 25 33E

Index File No. Z-1  
T 2S R. 33E  
Merid. Will.

CORNER RECORD (SEARCH) Tract-or Survey No. \_\_\_\_\_  
R.D. Ukiah County Umatilla  
N.F. Umatilla State Oregon

66  
Cor. No. ~~\_\_\_\_\_~~

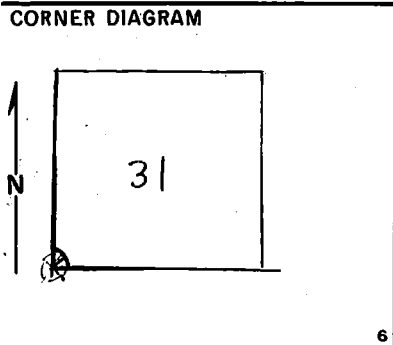

DESCRIBE CORNER MONUMENT FOUND  
Corner Stone: 18" x 12" x 10"  
6 notches on N + S faces.  
"CC" on E face

DESCRIBE BEARING TREES OR OTHER OFFICIAL ACCESSORIES FOUND  
Tamarack BT, 22" DBH, bears approx. N40E, 19 lks. Visible scribing consists of "3" only. Living.  
Fir BT (rotten remains). Scribing visible reads "... R32E T2S S36 ..."

PHOTO IDENTIFICATION DATA  
Photo No. EQ0(9-1-66), 7-245  
Filed At. \_\_\_\_\_  
Object Ident. Pine 21" DBH  
Ident. By M. Benson  
*Signature*

DESCRIBE CORNER LOCATION RELATIVE TO NEAR-BY FEATURES, ALSO HOW TO REACH CORNER  
Corner was found in Area of willow brush clumps on West-facing hillside (as described in 1891 notes) but 1891 notes states that corner is 88 lks W of draw, whereas I found it to be approx 45 lks E. of shallow draw.  
Access to area from road up Little Pearson

PLANE COORDINATE POSITION DATA  
State \_\_\_\_\_ Zone \_\_\_\_\_  
X \_\_\_\_\_  
Y \_\_\_\_\_  
Estab. By \_\_\_\_\_  
*Agency*

Signature: Ken Margoon

Title Eng. Aide Division USFS Headquarters Umatilla-SO. Date 8-13-69  
7100-52  
REV. 65 5

CORNER RECORD (PERPETUATION)

MONUMENT: DESCRIBE NEW MONUMENT SET, OR WORK DONE TO PRESERVE EXISTING MONUMENT

Painted cor. monument.

ACCESSORIES : DESCRIBE NEW BT'S WITNESS OBJECTS ETC. ESTABLISHED, OR WORK DONE TO PRESERVE EXISTING EVIDENCE

Posted "Attention" & "BT" and Cor Loc. tags.  
Flagged and Painted (red) BT (Tam.)  
Painted Fir BT remains and corner monument.

Work Done By MARVIN BENSON Title ENR Aide Date 8/13/69 State Registration No. US. FOREST SERVICE  
or Agency

Certified Cor. Record Prepared? Yes  No  Filed At: \_\_\_\_\_ Date \_\_\_\_\_

Pin Pricked Pine bears N17°E, 127 lks of corner. REMARKS

Index File No. Z-1 T. 2S R. 33E M. Will. Tract or Surv. No. \_\_\_\_\_ Cor. Z-1