

Index
File No. 2-11

CORNER RECORD (SEARCH)
(Ref. FSM 7151.4)

Tract or
Survey No. _____
Cor.
No. 1175

T 35 R. 33E R.D. LAGRANDE County UMATILLA
Merid. WILLAMETTE N.F. WALDWA-WHIT State OREGON

CORNER DIAGRAM

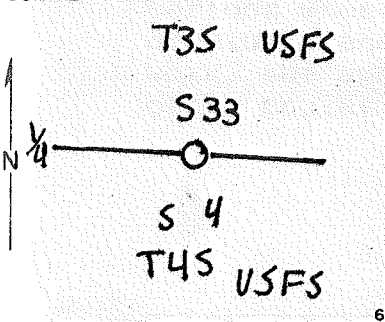

DESCRIBE CORNER MONUMENT FOUND

BLM 3 1/4" BRASS CAP ON 2 1/2" IRON PIPE
IN MOUND OF STONE 3" DIAMETER @ base
MARKED:

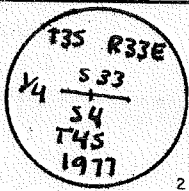

DESCRIBE BEARING TREES OR OTHER OFFICIAL ACCESSORIES FOUND

AN 11.5" D.F. BEARS N50°W, 37.0 FT. B'5 Y4 S 33 BT
A 40.5" D.F. BEARS S 67°E, 17.8 FT. BLAZE HEALED

PHOTO IDENTIFICATION DATA

Photo No. _____
Filed At. _____
Object Ident. _____
Ident. By _____
Signature

DESCRIBE CORNER LOCATION RELATIVE TO NEAR-BY FEATURES, ALSO HOW TO REACH CORNER

YELLOW TAG ON 9" D.F., "S 4°E 300' TO CORNER!"
FROM 2110 SW 1/4 ON 2110-044 .4 MI TO THE ABOVE
DESCRIBED YELLOW TAG

PLANE COORDINATE POSITION DATA

State _____ Zone _____
X _____
Y _____
Estab. By _____
Agency

Signature B. Sutton Title LS 1548 Division _____ Headquarters _____ Date 9-83 FS-7100-52 (3/68)

CORNER RECORD (PERPETUATION)

MONUMENT: DESCRIBE NEW MONUMENT SET, OR WORK DONE TO PRESERVE EXISTING MONUMENT

ADD EARTH AND STONES TO STABILIZE MOUND.

ACCESSORIES: DESCRIBE NEW BT'S WITNESS OBJECTS ETC. ESTABLISHED, OR WORK DONE TO PRESERVE EXISTING EVIDENCE

NONE

Work Done By B.A. SUTTON Title SURVEYOR Date 9-83 State Registration No. 1848
or Agency

Certified Cor. Record Prepared? Yes No Filed at ~~DELETED SURVEYORS OFFICE~~ Date

REMARKS

No

Index File No. 2-11 T. 25 R. 336 W.M. Tract or Surv. No. Cor. 1175

Index
File No. 2-11
T 3S R. 33S
Merid. Willamette

CORNER RECORD (SEARCH)

(Ref. FSM 7151.4)

Tract or Survey No. _____ Cor. No. _____
R.D. LaGrande County Union Umatilla
N.F. W-W State Oregon

CORNER DIAGRAM

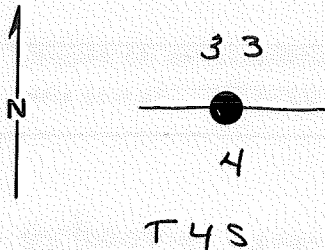

DESCRIBE CORNER MONUMENT FOUND

Original basalt stone 16x10x8" mtd 1/4 on N. face.

DESCRIBE BEARING TREES OR OTHER OFFICIAL ACCESSORIES FOUND

A root hole bears N 64° E, 44 lks dist. w/ a down + decayed pine along side, size indeterminate, w/ fragmentary scrub marks visible on decayed blaze. A fir, 48" dia, brs. S 67° E, 27 lks w/ healed blaze.

DESCRIBE CORNER LOCATION RELATIVE TO NEAR-BY FEATURES, ALSO HOW TO REACH CORNER

PHOTO IDENTIFICATION DATA

Photo No. _____
Filed At. _____
Object Ident. _____
Ident. By _____

Signature

PLANE COORDINATE POSITION DATA

State _____ Zone _____
X _____
Y _____
Estab. By _____

Agency

Signature

Title

Division

Headquarters

Date

FS-7100-52 (3/68)

CORNER RECORD (PERPETUATION)

MONUMENT: DESCRIBE NEW MONUMENT SET, OR WORK DONE TO PRESERVE EXISTING MONUMENT

Set Brass cap mkd: T3S R33E
1/4 533
54
T4S
1977

ACCESSORIES : DESCRIBE NEW BT'S WITNESS OBJECTS ETC. ESTABLISHED, OR WORK DONE TO PRESERVE EXISTING EVIDENCE

a Grand fir, 9" dia. bears N50°W, 57 lts dist., mkd. 1/4 S33 BT

Deposit corner stone alongside.

Work Done By. BLM Title _____ Date 1/78 State Registration No. _____ or Agency _____

Certified Cor. Record Prepared ? Yes No Filed At: _____ Date _____

REMARKS

Index
File No. Z 11
T 35 R. 33E
Merid. Will

CORNER RECORD (SEARCH)
(Ref. FSM 7151.4)

R.D. LAGRANDE County UNION
N.F. W-W State OREGON

Tract or Survey No. _____
Cor. No. S 1/4 Cor SEC 33

CORNER DIAGRAM

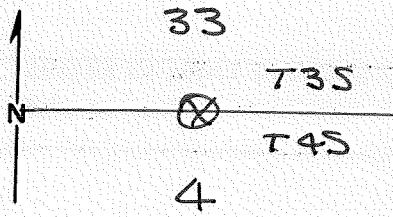

DESCRIBE CORNER MONUMENT FOUND

DESCRIBE BEARING TREES OR OTHER OFFICIAL ACCESSORIES FOUND

I don't have notes on this corner but
25" green P.P. bears N.E. . I posted road
about N 30° E , 5 chains BT has H.B.

PHOTO IDENTIFICATION DATA

Photo No. _____
Filed At. _____
Object Ident. _____
Ident. By _____
Signature

PLANE COORDINATE POSITION DATA

State _____ Zone _____
X _____
Y _____
Estab. By _____
Agency

DESCRIBE CORNER LOCATION RELATIVE TO NEAR-BY FEATURES, ALSO HOW TO REACH CORNER

Signature JOHN MITCHEL Title _____ Division _____ Headquarters _____

Date 9/21/76

CORNER RECORD (PERPETUATION)

MONUMENT: DESCRIBE NEW MONUMENT SET, OR WORK DONE TO PRESERVE EXISTING MONUMENT

ACCESSORIES : DESCRIBE NEW BT'S WITNESS OBJECTS ETC. ESTABLISHED, OR WORK DONE TO PRESERVE EXISTING EVIDENCE

Work Done By _____ Title _____ Date _____ State Registration No. or Agency _____

Certified Cor. Record Prepared ? Yes No Filed At: _____ Date _____

REMARKS

Index File No. T. R. M. Tract or Surv. No. Cor.

CORNER RECORD (SEARCH)

(Ref. FSM 7151.4)

Tract or Survey No. _____

Cor. No. Z-11

Index File No. Z-11

T 35 R. 33 E

R.D. Ukiah

County Umatilla

Merid. With

N.F. Umatilla

State Oregon

CORNER DIAGRAM

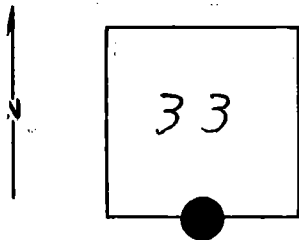

DESCRIBE CORNER MONUMENT FOUND SET

Brass Cap: 1977

DESCRIBE BEARING TREES OR OTHER OFFICIAL ACCESSORIES FOUND

PHOTO IDENTIFICATION DATA

Photo No. _____

Filed At. _____

Object Ident. _____

Ident. By _____

Signature

PLANE COORDINATE POSITION DATA

State _____ Zone _____

X _____

Y _____

Estab. By _____

Agency

DESCRIBE CORNER LOCATION RELATIVE TO NEAR-BY FEATURES, ALSO HOW TO REACH CORNER

Signature

Title

Division

Headquarters

Date

7100-52-(3/68)

CORNER RECORD (PERPETUATION)

GPO 902-673

MONUMENT : DESCRIBE NEW MONUMENT SET, OR WORK DONE TO PRESERVE EXISTING MONUMENT

9

ACCESSORIES : DESCRIBE NEW BT'S WITNESS OBJECTS ETC. ESTABLISHED, OR WORK DONE TO PRESERVE EXISTING EVIDENCE

10

Work Done By _____ Title _____ Date _____ State Registration No. or Agency _____

Certified Cor. Record Prepared? Yes No . Filed At: _____ Date _____

11

REMARKS

12

Index- File No. T. R. M. Tract or Surv. No. Cor. 13

Index

File No. A-11

CORNER RECORD (SEARCH)

(Ref. FSM 7151.4)

Tract or
Survey No. _____Cor.
No. _____

A-11

T 4 S. R. 33 E.R.D. UKIAHCounty UMATILLAMerid. W.N.F. UMATILLAState ORE.

CORNER DIAGRAM

DESCRIBE CORNER MONUMENT FOUND

stone 16" x 10" x 8", 8" above ground, in good
condition, marked $\frac{1}{4}$
Monumented

DESCRIBE BEARING TREES OR OTHER OFFICIAL ACCESSORIES FOUND.

Bts. 36" D.B.H. FIR bRS. S. 72° E.

ONE Bt. is dead AND down AND in poor condition.

PHOTO IDENTIFICATION DATA

Photo No. _____

Filed At. _____

Object Ident. _____

Ident. By _____

Signature

PLANE COORDINATE POSITION DATA

State _____ Zone _____

X _____

Y _____

Estab. By _____

Agency

Signature MLCTitle FOR. TECH.

Division _____

Headquarters _____

Date 5-28-70 7100-52 (3/68)

CORNER RECORD (PERPETUATION)

MONUMENT : DESCRIBE NEW MONUMENT SET, OR WORK DONE TO PRESERVE EXISTING MONUMENT

9

ACCESSORIES : DESCRIBE NEW BT'S WITNESS OBJECTS ETC. ESTABLISHED, OR WORK DONE TO PRESERVE EXISTING EVIDENCE

10

Work Done By _____ Title _____ Date _____ State Registration No. or Agency _____

Certified Cor. Record Prepared ? Yes No Filed At: _____ Date _____

11

REMARKS

12

Index File No. *A-11* T. R. M. Tract or Surv. No. Cor. 13

Index File No. ZTTA-11
T 35 R. 33E
Merid. Will

CORNER RECORD (SEARCH)
(Ref. FSM 7151.4)

R.D. LAGRANDE County UNION
N.F. W-W State OREGON

Tract or Survey No. _____

Cor. S 1/4 COR
No. SEC 33

CORNER DIAGRAM

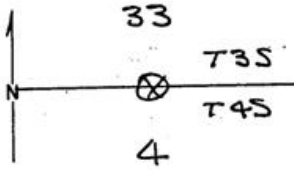

DESCRIBE CORNER MONUMENT FOUND

DESCRIBE BEARING TREES OR OTHER OFFICIAL ACCESSORIES FOUND

I don't have notes on this corner but 25" green P.P. bears N.E. I posted road about N 30° E, 5 chains BT has N.B.

PHOTO IDENTIFICATION DATA

Photo No. _____
Filed At. _____
Object Ident. _____
Ident. By _____
Signature

PLANE COORDINATE POSITION DATA

State _____ Zone _____
X _____
Y _____
Estab. By _____
Agency

Signature JOHN MITCHEL

Title _____

Division _____

Headquarters _____

Date 9/21/76

7100-52 (3-68)

RECEIVED BY
[Signature]

UNION COUNTY SURVEYOR

Date Received _____

Date Filed 12-21-87

By S. LANGLITZ, DEPUTY

File No. 273-87R

ZTTA-11