

OREGON CORNER RESTORATION FORM

SECTION 19 TOWNSHIP 4 NORTH RANGE 29 EAST N-1
 COUNTY : UMATILLA DATE 01-2002

CORNER DESIGNATION

NW COR

- CONDITION REPORT ONLY
- NOT FOUND
- RENEWED
- UNCOVERED
- SURVEYED IN
- REFERENCED

PREVIOUS RENEWALS / SURVEYS, ETC.

ORIGINALLY SURVEYED IN OCT. 1860 UNDER CONTRACT #95. W.B. CAMPBELL SET POST, DROVE CHARRED STAKE, MADE PITS AND MOUNDS.
 IN 1954, HIGGINS SET 1 1/4" IRON PIPE.
 IN 1973 KRUMBEIN SET 2 1/2" BRASS CAP BY PROPORTION.
 IN 1980, KRUMBEIN SET 2 1/2" BRASS CAP IN PLACE OF HIGGIN'S IRON PIPE.

MONUMENTS AND ACCESSORIES FOUND: CONDITION AND SOURCE

FOUND A 2 3/8" BRASS CAP 5" BELOW THE SURFACE OF GRAVELED ROAD STAMPED AS BELOW.
 FROM WHICH:

THE SW CORNER OF CONCRETE SIPHON BOX BEARS N 31°08'43" E 35.68 FEET
 AN ALUMINUM TAG #951 IN A BRACE POLE BEARS N 72°16'47" E 45.38 FEET
 AN ALUMINUM TAG #951 IN A POWER POLE BEARS S 67°51'54" E 46.49 FEET
 A 5/8"X30" REBAR WITH ALUMINUM TAG #951 BEARS S 45°05'31" W 46.31 FEET
 KRUMBEIN 1973 BRASS CAP LIES N 35°31'00" E 22.93 FEET

MONUMENT DETAIL

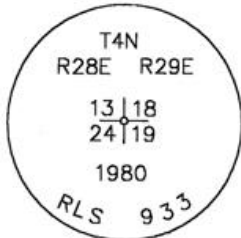

NAD 83/91
 OREGON STATE PLANE
 INTERNATIONAL FEET
 787622.1259
 8521135.2130

SKETCH

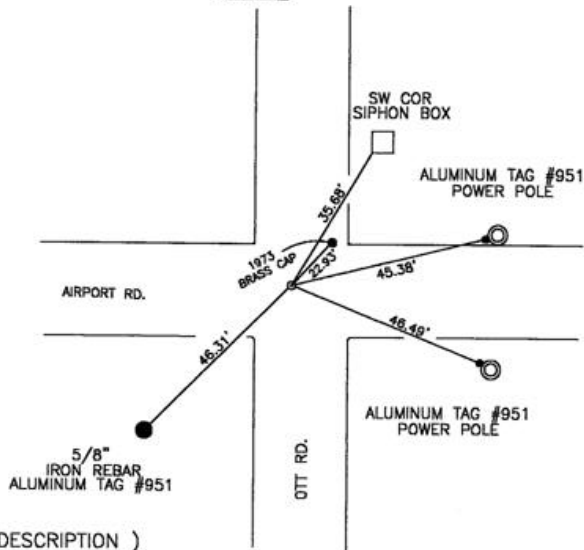

MONUMENT SET (PROCEDURES AND DESCRIPTION)

NA

NEW ACCESSORIES FROM WHICH

NA

LOCATION AND COMMENTS

INTERSECTION OF AIRPORT RD.
 AND OTT RD.

COMPASS DEC.

FIRM/AGENCY
 EDWARDS SURVEYING
 P.O. BOX 763
 HERMISTON, OREGON 97838

PARTY CHIEF
 CURTIS FAVOREL

NOTES

WITNESS
 WALT MUNDELL

SURVEYOR'S SEAL

REGISTERED
 PROFESSIONAL
 LAND SURVEYOR

G. Dennis Edwards

OREGON
 JULY 16, 1971
 G. DENNIS EDWARDS
 9 5 1

RECEIVED BY _____ RENEWS 12/31/2003

Umatilla County Surveyor

Date 2-02

Rec'd By KK

No. 02-48-9