

OREGON CORNER RESTORATION FORM

Section 33 Township 4 N Range 29 E

County UMATILLA Date 3/95

V-13

CORNER DESIGNATION

NE Cor.

- Condition Report Only
- Not Found
- Renewed
- Unrecorded
- Surveyed In
- Referenced Out

Previous Renewals/Surveys, etc. ORIG SUR. DAVENPORT 1861 # 101

He set a post in mound with charred stake.

Krumbein Set RR spike & BC WC. 1993

Monument(s) & Accessories Found: (Condition and Source)

End RR Spike

End 2 1/2" BC WC. Stamped as below S 39° 36' 26" W 31.89 FT.

Monument Detail

Sketch

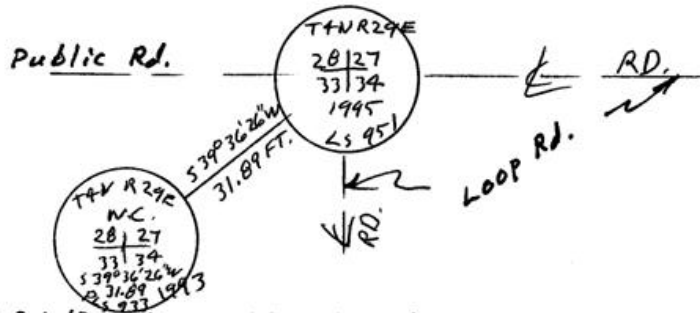

Monument Set (Procedures and Description)

In place of Krumbein's RR spike I set 1" x 30" I. Pipe with 2 3/8" BC. stamped as above

SEE MY 1994-1 COUNTY PUBLIC MONUMENTATION SUR.

New Accessories

Alum Tag # 951 in P. Pole Bears N 47° 38' 36" E 28.62 FT.

" " " sawed off " " S 77° 34' 44" E 96.82 FT.

" " " in 36" Cottonwood N 58° 01' 04" W 48.87 FT.

Location & Comments

at a cor. of
Stanfield Loop Rd
East & South &
Public Rd. West.

Compass Declination _____
Firm/Agency EDWARDS
SURVEYING
Address P. Box 763
HERMISTON, OR 97838
Party Chief D. EDWARDS
Notes _____
Witness J. COPPOCK

Surveyor's Seal

REGISTERED
PROFESSIONAL
LAND SURVEYOR

G. Dennis Edwards

OREGON
JULY 16, 1971
G. DENNIS EDWARDS
951

RENEWS 12/31/95

RECEIVED BY

Umatilla County Surveyor

Date _____

Rec'd by _____

No. 95-60-B