

OREGON CORNER RESTORATION FORM

SECTION 30.31 TOWNSHIP 4 NORTH RANGE 29 EAST

V-3

COUNTY : UMATILLA DATE 01/02

CORNER DESIGNATION

1/4 CORNER

CONDITION REPORT ONLY

NOT FOUND

RENEWED

UNCOVERED

SURVEYED IN

REFERENCED

PREVIOUS RENEWALS / SURVEYS, ETC.

ORIGINALLY SURVEYED IN 1861 BY DAVENPORT UNDER CONTRACT #101. HE SET A POST IN A MOUND OF EARTH AND A CHARRED STAKE.

IN 1973 KRUMBEIN SET A BRASS CAP.

IN 1998 HADDOCK RESET THE BRASS CAP FROM EXISTING REFERENCES.

MONUMENTS AND ACCESSORIES FOUND: CONDITION AND SOURCE

A 1 1/4" x 34" REBAR MKD 951 LIES S 89°46'30" W, 10.00 FEET.

A 1/2" x 24" REBAR WITH ALUMINUM CAP LIES N 00°15'51" W, 9.88 FEET.

A 3/4" x 27" IRON PIPE MKD #951 LIES S 89°32'17" E, 10.01 FEET.

MONUMENT DETAIL

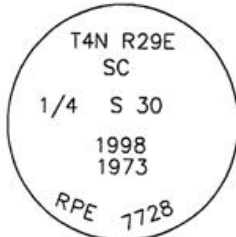

NAD 83/91
OREGON STATE PLANE
INTERNATIONAL FEET

777141.2285
8524519.0118

SKETCH

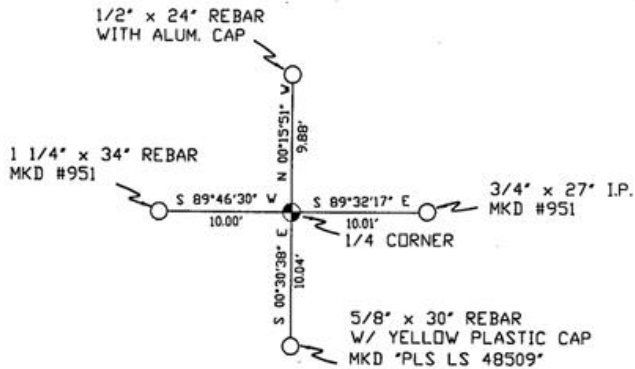

MONUMENT SET (PROCEDURES AND DESCRIPTION)

NEW ACCESSORIES FROM WHICH

A 5/8" x 30" REBAR WITH PLASTIC YELLOW CAP MKD "PLS LS 48509" LIES S 00°30'38" E, 10.04 FEET.

RECEIVED BY

Umatilla County Surveyor

Date 2-02

Rec'd By KK

No. 02-49-g

SURVEYOR'S SEAL

LOCATION AND COMMENTS

FROM WOOD ST. IN STANFIELD
GO ALONG PAVED RD ON NORTH
EDGE OF R&R TRACKS 0.9 MILES
THEN NORTHERLY ON DIRT ROAD
0.1 MILES TO CORNER ON
SOUTHERLY CANAL BANK.

COMPASS DEC.

FIRM/AGENCY
PRIMM LAND SURVEYING
P.O. BOX 1322
HERMISTON, OREGON 97838

PARTY CHIEF
KEITH P. PRIMM

NOTES

WITNESS
BRIT L. PRIMM

REGISTERED
PROFESSIONAL
LAND SURVEYOR

Brit L. Primm
OREGON
JULY 13, 1999
BRIT L. PRIMM
48509

EXPIRATION DATE:12/31/02