

OREGON CORNER RESTORATION FORM

COUNTY: Umatilla DATE: 02/27/07

CORNER DESIGNATION: 4N30, E-19, The North One-Quarter of Section 11.

PREVIOUS RENEWALS/SURVEYS ETC.:

Corner was originally established by Dolphus S. Payne, under Contract No. 100, dated August 1, 1861. Notes state: Set charred stake with mound, trench, and pits as per instructions.

MONUMENT AND ACCESSORIES FOUND: None. Corner location in farmed field.

MONUMENT MARKING DETAIL:

T4N R30E
1 S2
4 S11
2007
PLS 1106

MONUMENT SET:

At a point determined by single proportionate measure between the monumented NW Corner of Section 11 and the reestablished NE Corner of Section 11, set a 2 3/8 " brass cap on 1 1/4" x 30" galvanized iron pipe with top of cap 14" below ground level. Monument marked as shown in monument marking detail.

New Accessories:

- A Silver Deep-1 magnet buried 20" below ground level bears North 25° East, 22.5 feet.
- A Blue Deep-1 magnet buried 20" below ground level bears South 28° East, 33.2 feet.
- A Purple Deep-1 magnet buried 20" below ground level bears South 28° West, 34.2 feet.
- A Orange Deep-1 magnet buried 20" below ground level bears North 54° West, 32.0 feet.

Buried bearing object signs with all magnets. Set steel fence post with witness sign attached 1 foot East of monument.

LOCATION AND COMMENTS: Corner is located in an actively farmed field.

FIRM: William R. Wells, PLS
P.O. Box 1696
Pendleton, OR 97801

COMPASS DECLINATION: 18° East

Surveyor's Seal

Witnesses: Jason Wells, LSIT
Micah Engum

/4N30E19

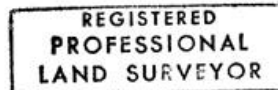

William R. Wells

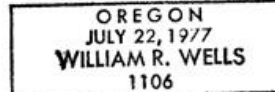

renews 6-30-08