

OREGON CORNER RESTORATION FORM

COUNTY: Umatilla DATE: 02/13/07

CORNER DESIGNATION: 4N31, L-7, The Center One-Quarter Corner of Section 17.

PREVIOUS RENEWALS/SURVEYS ETC.: There is no record of previous establishment of this corner found in County Survey Office Records.

MONUMENT AND ACCESSORIES FOUND: Corner was established by survey as indicated on accompanying Record of Survey.

CORNER IDENTIFICATION:

T4N R31E

C 1/4 S17

MONUMENT SET:

At position determined by survey, set a 5/8" by 30" iron rebar 28" in the ground, capped with a 1 1/4" red plastic cap marked OR PLS 1106 WA PLS 17372".

New Accessories:

A silver deep-1 magnet buried 20" in the ground bears North 50° East, 23.2 feet.

A blue deep-1 magnet buried 20" in the ground South 35° East, 33.5 feet.

A purple deep-1 magnet, buried 20" in the ground bears South 39° West, 30.5 feet.

A orange deep-1 magnet, buried 20" in the ground bears North 38° West, 28.1 feet.

Buried bearing object sign with each deep-1 magnet accessory. Set steel fence posts 1' South of monument and 1' North of the monument with witness signs attached.

LOCATION AND COMMENTS:

Corner falls in farmed field. A steel fence post referencing Triangulation Station Laurila azimuth mark bears South 41°43' West, 96 feet from corner.

FIRM: William R. Wells, PLS
P.O. Box 1696
Pendleton, OR 97801

COMPASS DECLINATION: 18° East

Witnesses: Jason Wells, LSIT
Micah Engum

/4N31L7

Surveyor's Seal

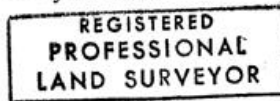

Will R. Wells

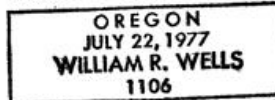

renews 6-30-08