

OREGON CORNER RESTORATION FORM

Section: 1
Township: 4 North
Range: 33 East of the Willamette Meridian
County: Umatilla
Date: 01/30/02

Corner Indexing Information: Township 4N Range 33E Corner Code A-21 (Willamette Meridian)

Additional Identifier: (e.g. BLM designation for the corner, street intersection, plat name, block, lot, etc.)

NW Corner Section 1 (Closing Corner)

Oregon Plane Coordinates: N: 805827.892 E: 8675247.842

Zone: North Order: second Datum: NAD83-91 Convergence: 1°19'01.9" Scale Factor: 0.99987417

Previous Renewals/Surveys, etc.:

Corner was originally set in 1866 by Odell and Lewis under contract #110 as a charred stake, mound and pits. It was set as a closing corner 6.50 chains West of the Standard Corner.

In 1985, Krumbein set a brass cap on pipe. (C.S. 85-31-B.)

In 1999, Haddock found a 2 1/4" brass cap on 1 1/8" pipe. (C.S. 99-299-B.)

Monument(s) & Accessories Found (Condition & Source):

Found a 2 1/2" brass cap on a 1 1/2" pipe on the Southwest side of a post. Sign is attached to post.

Monument Set (Procedures & Description):

Monument Detail:

FOUND 2 1/2" BRASS CAP ON 1" PIPE

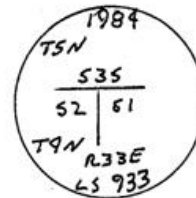

Location & Comments:

Compass Declination:

19° East

Surveyor's Seal

Firm/Agency: Tomkins Land Surveying, Inc.
20 E. Poplar, Suite 204
Walla Walla WA 99362

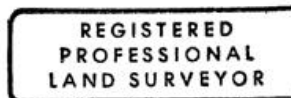

Paul W. Tomkins

Party Chief:

Notes:

Witness:

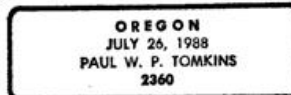

renews 6/30/04

2/2/03

RECEIVED BY

Umatilla County Surveyor

Date 2-03

Rec'd By *PK*

No. 03-28-9