

OREGON CORNER RESTORATION FORM

Section: 2
Township: 4 North
Range: 34 East of the Willamette Meridian
County: Umatilla
Date: 01/30/02

Corner Indexing Information: Township 4N Range 34E Corner Code A-21 (Willamette Meridian)

Additional Identifier: (e.g. BLM designation for the corner, street intersection, plat name, block, lot, etc.)

Northeast corner Section 2

Oregon Plane Coordinates: N:806131.943 E: 8706895.903

Zone: North Order: second Datum: NAD83-91 Convergence: 1°24'19.0" Scale Factor: 0.99987582

Previous Renewals/Surveys, etc.:

Corner was originally set by Odell and Lewis in 1866 under contract no. 114 as a charred stake, pits, and mounds. This is a corner set as a closing corner on the Standard Parallel.

In 1988, Staebler re-established this corner from ties to nearby railroad, setting a 1" pipe with 2 1/2" brass cap, and accessories North and South. (C.S. 88-09-A)

Monument(s) & Accessories Found (Condition & Source):

Found brass cap by Staebler 10" deep with accessories as shown below.

Monument Set (Procedures & Description):

Monument Detail:

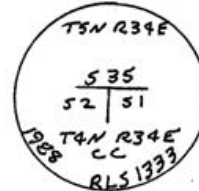
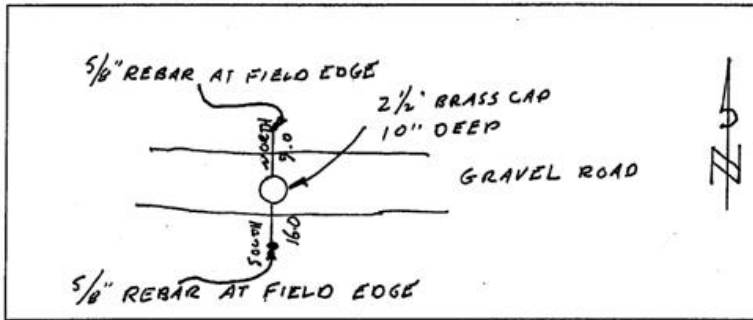

Location & Comments:

Compass Declination:
19° East

Surveyor's Seal

Firm/Agency: Tomkins Land Surveying, Inc.
20 E. Poplar, Suite 204
Walla Walla WA 99362

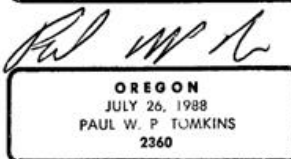
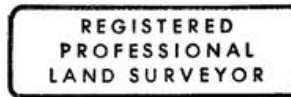

Party Chief: PWPT
Notes:
Witness: JLD

renews 6/30/04
2/11/03

RECEIVED BY

Umatilla County Survey

Date 2-03

Rec'd By KK

No. 03-29-9