

OREGON CORNER RESTORATION FORM

COUNTY: Umatilla. DATE: 06/10/08

CORNER DESIGNATION: T4N R34E, W.M., P-21, The West One-Quarter Corner of Section 24.

PREVIOUS RENEWALS/SURVEYS ETC.:

Corner originally established by W. H. Odell under GLO Contract No. 114 dated July 2, 1866. Notes state: "Set post corner for 1/4 section drove charred stake, dug pits, and raised mound as per instructions". Oregon State Highway map No. 6B-16-19, dated Sept. 1945 shows a "I.P." set 30' North and South a unnamed symbol designating the 1/4 corner. Neither of the "I.P.s" were recovered.

MONUMENT AND ACCESSORIES FOUND: None.

MONUMENT MARKING DETAIL:

T4N R34E
1
4
S23 | S24
2008
PLS 1106

MONUMENT SET:

Held point at the intersection of the centerline of the Athena-Holdman Highway and a field berm extending South. At the reestablished corner point, set a 2" brass cap on 5/8" x 12" copper coated round bar with brass cap 1/4" below asphalt road surface. Placed cement grout around brass cap. Monument marked as shown in monument marking detail.

New accessories:

- A 5/8" x 24" iron rebar with 1 1/4" red plastic cap marked "OR PLS 1106 WA PLS 17372", 2" above ground level in road bank bears North 57° East, 38.9 feet.
 - A 5/8" x 24" iron rebar with 1 1/4" red plastic cap marked "OR PLS 1106 WA PLS 17372", 2" above ground level in road bank bears South 47° East, 42.0 feet.
 - A 3" dia. Oregon State Highway Department brass cap bench mark set in a concrete pedestal in road bank bears South 00°42'21" West, 26.60 feet.
 - A 5/8" x 24" iron rebar with 1 1/4" red plastic cap marked "OR PLS 1106 WA PLS 17372", 2" above ground level in road bank bears North 45° West, 39.7 feet.
- Attached bearing object signs to all rebar accessories.

LOCATION AND COMMENTS: Corner is located in the centerline of the Athena-Holdman Highway at a field berm extending South.

FIRM: Wells Surveying
P.O. Box 1696
Pendleton, OR 97801

COMPASS DECLINATION: 18° East

Surveyor's Seal

Witnesses: Jason Wells, LSIT

\4N34P21

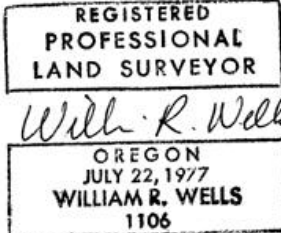

renews 6-30-08

RECEIVED BY
Umatilla County Surveyor
Date 6-08
Rec'd By DJ
No. 08-084-C