

OREGON CORNER RESTORATION FORM

COUNTY: Umatilla DATE: 10/17/00

CORNER DESIGNATION: G-17, West 1/4 Corner Section 11, T4N., R35E., W.M..

PREVIOUS RENEWALS/SURVEYS ETC.: This corner was established by William Odell, U.S. Deputy Surveyor, under Contract No. 114, dated 2 July 1866. The original notes state: Set post Cor, for 1/4 Sec., drove charred stake, dug pits and raised mound as per instructions. Corner re-established by Wells, PLS 1106, on March 8, 1991, Umatilla County Surveyor Record #91-17-C. Notes state: The Athena-Blue Mountain Section State Highway Map (drawing 8B-10-25 dated June & November 1960) shows a state plane co-ordinate for corner, no monument indicated. No evidence found. After locating certain existing state highway monuments and determining their state plane co-ordinate basis, I re-established this corner based on state highway tie as shown on state map (Dwg. 8B-10-25). Set 2 1/2" brass cap on 1 1/4" by 30" galvanized iron pipe with top of cap buried 18" below ground line. Set steel fence post 3 1/2' North of corner and attached witness corner sign. New Accessories: Aluminum nail with PLS 1106 washer nailed to East side of most Sly 12" deciduous tree in N-S line of trees bears N 18 1/2° E - 158.6 feet. Alum. Nail with PLS 1106 washer nailed to East side of 18" deciduous tree bears S 67° W - 106.3 feet. Centerline of an 8" well casing bears S 04° E, 306.2 feet. 5/8" pin at Engr's Centerline Station 1094+00 on the west side (R/W) of State Hwy 11 bears N 67°55'45" W - 208.35 feet. Attached bearing object signs to the 2 tree references and to a power pole 3' West of the 5/8" pin.

MONUMENT AND ACCESSORIES FOUND: Found 2 1/2" brass cap monument buried 18" below ground line, monument marked as shown in "Monument Marking Detail". Found steel fence post 3 1/2' North of corner with witness corner sign. An aluminum nail with PLS 1106 washer nailed to East side of most Southerly 12" deciduous tree in N-S line of trees bears N 18 1/2° E, 158.6 feet. An aluminum nail with PLS 1106 washer nailed to East side of 18" deciduous tree bears S 67° W, 106.3 feet. Centerline of an 8" well casing bears S 04° E, 306.2 feet. 5/8" rebar at Engineers Centerline Station 1094+00 on the west side (r/w) of State Highway 11 bears N 67°55'45" W, 208.35 feet. Bearing object signs are attached to the two trees and to a power pole 3' West of the 5/8" rebar.

MONUMENT MARKING DETAIL:

T4N R35E
1/4
S10|S11
1991
PLS 1106

LOCATION AND COMMENTS: Corner is located in a farmed field North of the Winn Strawberry Stand building.

OREGON STATE PLANE COORDINATES, North Zone, NAD 83(91), International Feet:

N = 799447.29
E = 8733368.51

FIRM: William R. Wells, PLS
P.O. Box 1696
Pendleton, OR 97801

COMPASS DECLINATION: 18° East

Witnesses: Jason Wells
Kevin Snively
4N35G17

Surveyor's Seal

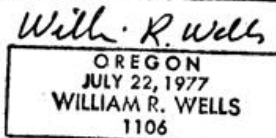
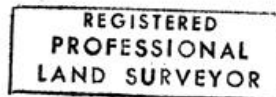

renews 6-30-00

02-12-C