

**OREGON CORNER RESTORATION FORM**

COUNTY: Umatilla DATE: 12/31/01

CORNER DESIGNATION: L-9, West 1/4 Corner of Section 16, T4N., R35E., W.M..

PREVIOUS RENEWALS/SURVEYS ETC.: Corner originally established by Wm. H. Odell, under Contract No. 114, dated July 2nd, 1866. Record states: Set post Cor. for 1/4 Sec.; drove charred stake, dug pits and raised mound as per instructions. Corner reestablished by J. C. Arnold, County Surveyor, on Umatilla County Survey No. 44, recorded at Book 1, Page 221. Record states: Set a basalt stone 16x8x5 ins., 18 ins. In ground for 1/4 sec. Cor bet. Secs. 16 & 17, marked 1/4 on W. face, 89 ft. N. of center of R.R. track and about 5 ft. E. of cor, fences S. and W..

**MONUMENT AND ACCESSORIES FOUND:**

None. The corner area has been extensively farmed. There are field lines extending North and East and West from the corner area.

**MONUMENT MARKING DETAIL:**

T4N R35E  
1/4  
S17|S16  
2001  
PLS 1106

**MONUMENT SET:**

At a point 89.0 feet North of the centerline of the former location of the Oregon-Washington Railroad and Navigation Company railroad tracks, at a point where field lines extend North and East and West, set a 2 1/2" brass cap on 1 1/2" by 30" galvanized iron pipe, 28" in the ground, marked as shown on "Monument Marking Detail", from which:

- A silver "deep-1" magnet, buried 20" in the ground, bears N 29° E, 38.1 feet.
- A purple "deep-1" magnet, buried 20" in the ground, bears S 41 1/2° E, 33.0 feet.
- A blue "deep-1" magnet, buried 20" in the ground, bears S 46° W, 36.1 feet.
- A orange "deep-1" magnet, buried 20" in the ground, bears N 39° W, 40.6 feet.

Buried bearing object signs alongside "deep-1" magnets. The corner monument is located 1 foot West of the West edge of a power transmission line pole.

**LOCATION AND COMMENTS:**

OREGON STATE PLANE CO-ORDINATES, North Zone, NAD 83 (91), International Feet:

N: 794065.50  
E: 8723032.21

FIRM: William R. Wells, PLS  
P.O. Box 1696  
Pendleton, OR 97801

COMPASS DECLINATION: 18° East

Surveyor's Seal

Witnesses: Jason Wells, LSIT  
Mark Hammersla

14N35L9

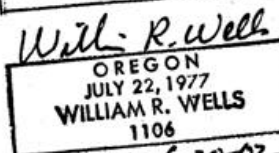
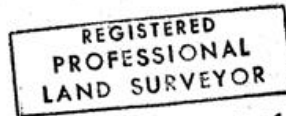

02-12-C